

DESIGN NO. GP/WA 120-03

ASSEMBLY RATING: 2 HOURS WITH EXPOSURE ON FIRE SIDE

RESTRICTED NON-BEARING;

NON-SYMMETRICAL AREA SEPARATION WALL

DESIGN WEIGHT: 11 PSF

TESTED UNDER LOAD SIMULATING A WALL HEIGHT OF 68'

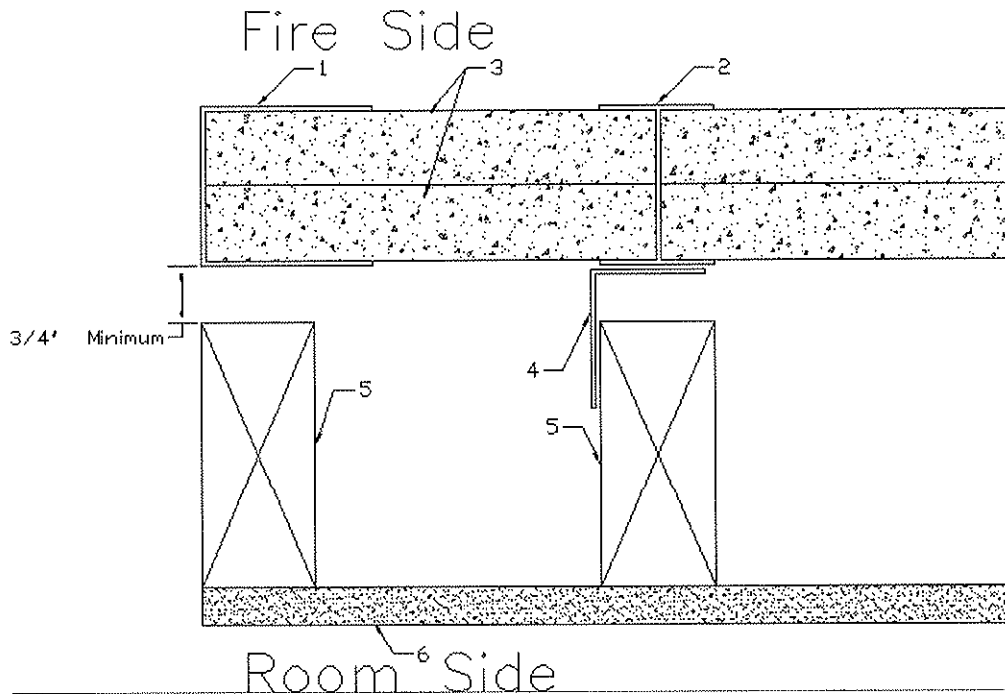

1. Floor, Upper Corner, and Intersection Runner: 'U' shaped runner, 2-1/8" deep roll-formed from minimum 0.018" thick galvanized steel. Position runners at 3/4" minimum spacing from wood framing members. Runners attached to foundation or structural members with steel fasteners located not greater than 24" oc Floor, Upper Corner, and Intersection Runners to be supplied by others.
2. Steel Studs: 'H' shaped studs, 1-1/2" wide x 2" deep, roll-formed from minimum 0.018" thick galvanized steel. Cut to length 1/2" less than the openings height and spaced a maximum of 24" oc within runner legs and between layers of 1" thick gypsum shaftliner panels. Steel Studs to be supplied by others.
3. Gypsum Shaftliner*: 1" thick ToughRock Fireguard® Shaftliner or 1" Dens-Glass Ultra Shaftliner, Type X panels, supplied in nominal 24" widths. Two panels are inserted against the web of the 'U' runners into the 2" deep recess of the studs.
4. Aluminum Clips: 2" long x 2" or 2-1/2" legs x 0.050" thick aluminum angle, spaced 108" oc maximum vertically, to wood framing with 4d box nails or 1-1/4" drywall screws and to steel stud flanges with framing screws.
5. 2" x 4" nominal wood framing, spaced 16" oc maximum.
6. Gypsum Wallboard: 1/2" thick, 4'0" wide GP Gypsum Corp. ToughRock or DensArmor Plus, gypsum wallboard applied on the room side with 5d drywall nails 8" oc. Joints are finished with paper tape and joint compound. Exposed nail or screw heads are covered with joint compound. Limitations: Parapet construction may be required by local code. Allowance: 2" thick 'H' Stud and Shaftliner Wall provides 120 minute protective membrane rating for framing with 3/4" separating.

*Component bearing the Warnock Hersey Certification Mark