

## Design No. DFG 100

## DOOR and FRAME GUARDS

Assembly Rating: 1 1/2 hr

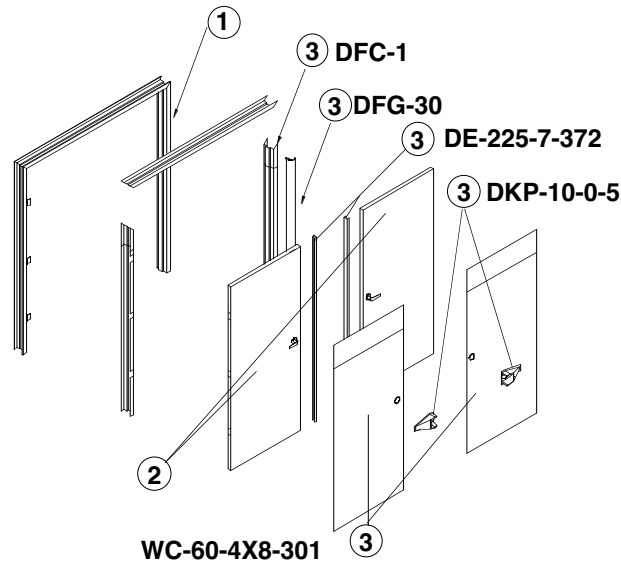

1. **DOOR FRAME:** The door frame is a laminated architectural fire door frame, manufactured from various species of hardwoods, that is constructed of solid wood pieces and that has been fire-resistant rated for 90 minutes. The size of the single door frame shall not exceed the width to house two 3'-6" wide by 9'-0" tall swinging doors, with fixed astragals attached to both the active and inactive leaves. Door frames of the same or lesser dimensions that are rated for 90 minutes are also approved.
2. **DOORS:** The door, or doors, is a laminated stile and rail configured, fire door, which has been fire-resistant rated for 90 minutes. The maximum size of the swing door is 42 in. wide by 108 in. tall. There should be a maximum of two swinging doors in a single frame, with fixed astragals attached to both the active and inactive leaves. Doors of the same or lesser dimensions are approved; assuming the width of the stiles and rails is not decreased. The door core consists of a 1-3/4 in. thick slab of noncombustible panel covered with 1/4 in. thick white oak glued to the core material. The minimum completed door thickness is 2-1/2 in. The side and top edges of each door are fitted with intumescent strips. The inactive leaf is fitted with automatic flush bolts and rust proof strikes. The active leaf contains a lock with an extra heavy duty lever lock set having a minimum 3/4-in. latch throw.
3. **DOOR TREATMENT:** Any combination of protection can be used on the door and frame. Both surfaces of the doors can be completely or partially covered with the Pawling Corporation's WC-60-4x8-301 Vinyl Sheet material. The following methods of attachment are approved: ADH-30-1-0 Adhesive, ADH-2000-1-0 Adhesive and #8 x 1/2" screws 12" on center. The door latch can be fitted with the DKP-10-0-5 Door Knob Protector. The frame can be lined on all three sides with formed PVC sheet Door Frame Protectors. The finished door assembly can be fitted with the Pro•Tek® Door Frame Guards DFG-30.

**Listed Manufacturer**

Pawling Corporation

Door, Wall &amp; Corner Guards

Rigid PVC Profiles

Door Impact Protection System

Protek® PVC 1-1/2 Hour Door Coverings