

Design No. DFG 102

DOOR and FRAME GUARDS

Assembly Rating: 1 1/2 hr

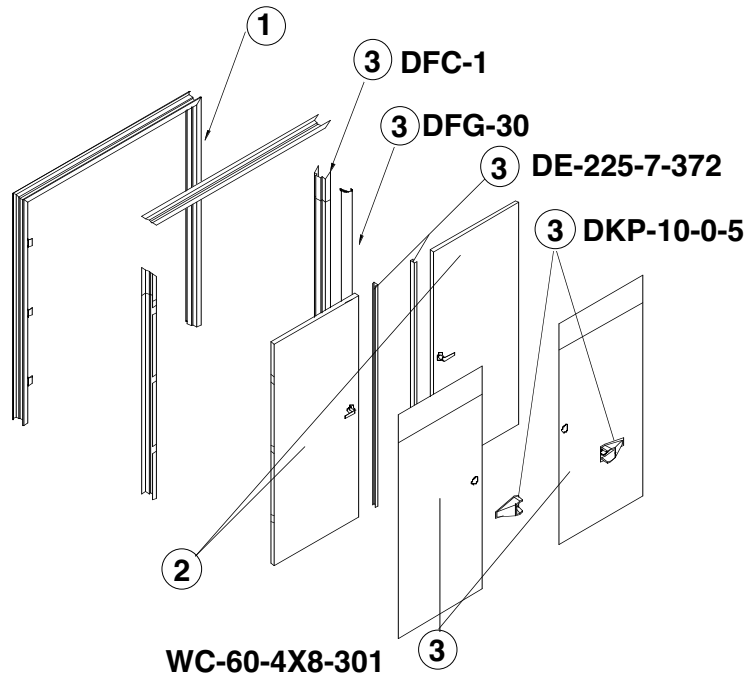

1. **DOOR FRAME:** The door frame is a metal frame that has been fire-resistant rated for 90 minutes. The inside of the hollow steel frame is filled with grout. The size of the single door frame shall not exceed the width, to house two 42-inch wide by 108-inch tall swinging doors. Door frames of the same or lesser dimensions that are rated for 90 minutes are also approved.
2. **DOORS:** The doors, are single hung hollow steel fire doors, which has been fire-resistant rated for 90 minutes. The maximum size of the swing door is 48 in. wide by 108 inches tall. There should be a maximum of two swinging doors in a single frame, with fixed astragals attached to both the active and inactive leaves. Doors of the same or lesser dimensions are approved. The minimum completed door thickness is 2-1/2 in. The active leaf contains a latch set having a minimum 5/8-in. latch throw. Three steel 4.5" x 4" hinges hold the door in the frame.
3. **DOOR TREATMENT:** Any combination of protection can be used on the door and frame.

Both surfaces of the doors can be completely or partially covered with the Pawling Corporation's WC-60-4x8-301 Vinyl Sheet material. The following methods of attachment are approved: ADH-30-1-0 Adhesive, ADH-2000-1-0 Adhesive and #8 x 1/2" screws 12" on center. The door latch can be fitted with the DKP-10-0-5 Door Knob Protector. The frame can be lined on all three sides with formed PVC sheet Door Frame Protectors. The finished door assembly can be fitted with the Pro•Tek® Door Frame Guards DFG-30.

Listed Manufacturer

Pawling Corporation

Door, Wall & Corner Guards

Rigid PVC Profiles

Door Impact Protection System

Protek® PVC 1-1/2 Hour Door Coverings