

Design No. DFG 104

DOOR and FRAME GUARDS

Assembly Rating: 1 1/2 hr

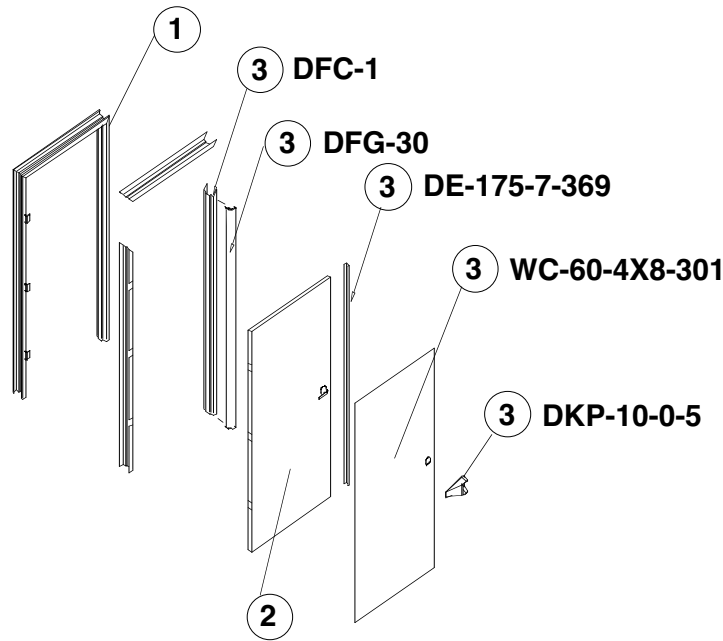

1. **DOOR FRAME:** The door frame is a laminated architectural fire door frame, manufactured from various species of hardwoods, that is constructed of solid wood pieces and that has been fire-resistant rated for 90 minutes. The size of the single door frame shall not exceed the width, to house one 3'-6" wide by 9'-0" tall swinging door. Door frames of the same or lesser dimensions that are rated for 90 minutes are also approved.
2. **DOORS:** The doors are laminated stile and rail configured, fire doors, which has been fire-resistant rated for 90 minutes. The maximum size of the swing door is 42 in. wide by 108 in. tall. Doors of the same or lesser dimensions are approved; assuming the width of the stiles and rails is not decreased. The door core consists of a 1-3/4 in. thick slab of noncombustible panel covered with 1/4 in. thick white oak glued to the core material. The minimum completed door thickness is 2-1/2 in. The side and top edges of each door are fitted with intumescent strips. The inactive leaf is fitted with automatic flush bolts and rust proof strikes. The active leaf contains a lock with an extra heavy duty lever lock set having a minimum 3/4 in. latch throw.
3. **DOOR TREATMENT:** Any combination of protection can be used on the door and frame. Both surfaces of the doors can be completely or partially covered with the Pawling Corporation's WC-60-4x8-301 Vinyl Sheet material. The following methods of attachment are approved: ADH-30-1-0 Adhesive, ADH-2000-1-0 Adhesive and #8 x 1/2" screws 12" on center. The door latch can be fitted with the DKP-10-0-5 Door Knob Protector. The frame can be lined on all three sides with formed PVC sheet Door Frame Protectors.

Listed Manufacturer

Pawling Corporation

Door, Wall & Corner Guards

Rigid PVC Profiles

Door Impact Protection System

Protek® PVC 1-1/2 Hour Door Coverings