

DESIGN NO. PS/PH 120-14
HORIZONTAL (FLOOR) SEE ITEM 1. RATINGS: ASTM-E814 - 2 HRS (F), 2 HRS (T)
TEST PRESSURE DIFFERENTIAL - 2.5 Pa (0.01" OF WATER) MINIMUM

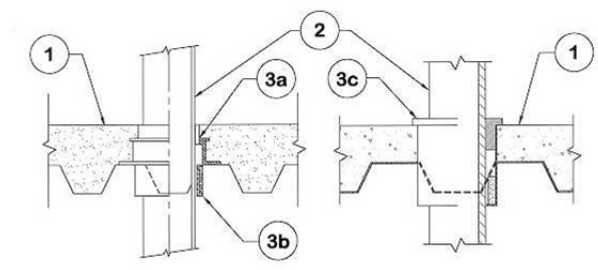

1	Floor: Minimum 2-1/2" concrete slab poured on corrugated metal flutes.
2	Pipe Material & Pipe Support: Maximum 4" FR PP, ABS, Cellular core PVC or FR PP. Support at penetration by solvent cementing the pass through pipe to the embedded PVC sleeve coupling device.
3	Firestop Device: a) Cast-In P2549H-G* 2", P3549H-G* 3" & P4549H-G* 4". b) Adjustable 26 gauge sheet metal insert collar with factory built-in intumescent wrap with maximum 2" collar extension to the bottom of the metal corrugations. c) ProSet Series #55 cored hole coupling with adjustable 26 gauge insert collar with a factory built-in intumescent wrap at the bottom.

*Components bearing the Warnock Hersey Certification Mark.