

Studco Building Systems
Design Number SBS/MSVCC 60-01
Loadbearing Floor Ceiling Assembly
RESILMOUNT A237R WALL AND CEILING CLIP AND A237 WALL AND CEILING CLIP
ASTM E119
Rating: 1 Hour Restrained, 1 Hour Unrestrained
Superimposed Load: 100% Design Load

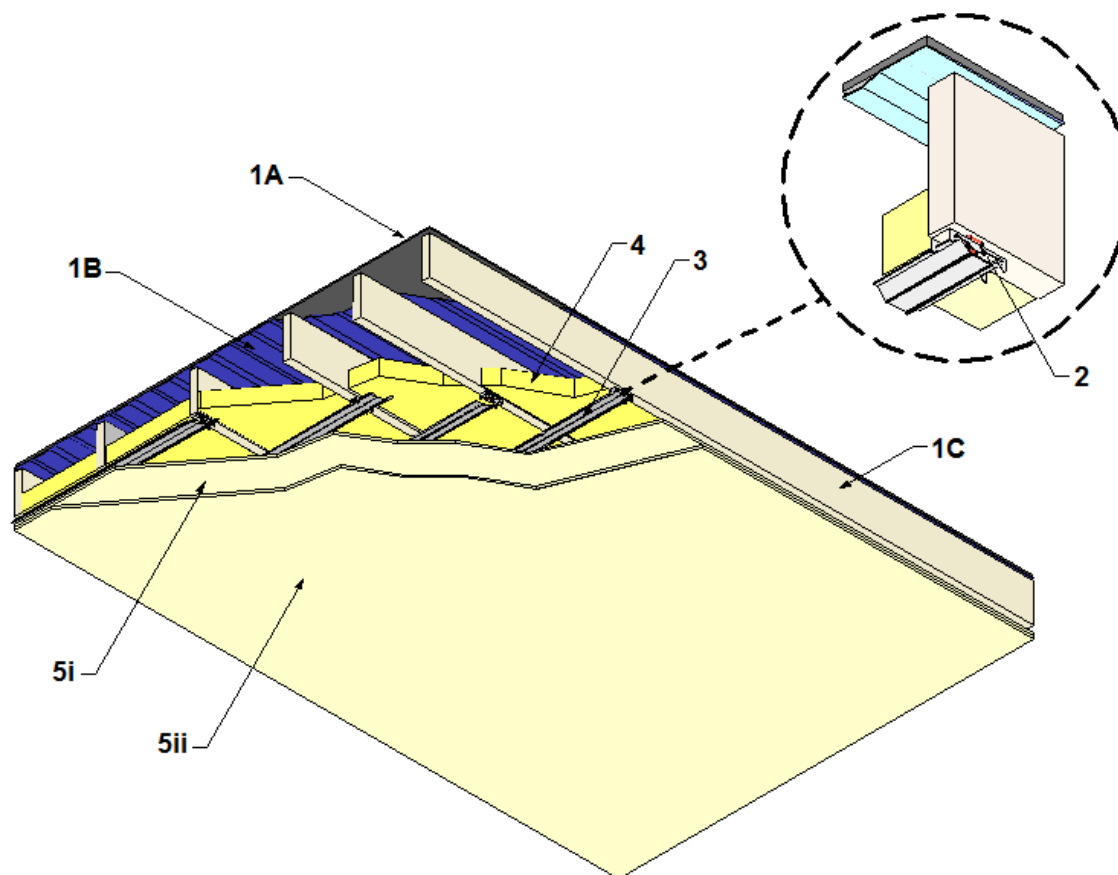

- 1. FLOOR-CEILING ASSEMBLY:** Construct a 1 hour rated gypsum floor-ceiling assembly using the following elements:

A. TOPPING: Install nominal 9/16 in. thick lightweight gypsum concrete topping (compressive strength 3500 – 4500 psi) applied to top of steel decking (Item 1B). Before applying the gypsum concrete topping, install floor underlayment primer (vinyl acetate adhesive) to cover the steel deck decking (Item 1B).

B. STEEL DECKING: Install nominal 9/16 in. deep 22 MSG galvanized

corrugated fluted steel deck, overlapped one corrugation at each side and attached to each wood joist (Item 1C) using approved fasteners. Install fasteners spaced max. 12 in. on center (oc) down the length of the wood joist (Item 1C).

C. WOOD JOISTS: Install nominal 2 x 10 in. SPF joists spaced a max. 24 in. oc, effectively fireblocked according to local codes.

- 2. CERTIFIED MANUFACTURER:**
Studco Building Systems

CERTIFIED PRODUCT: Sound and Vibration Control Equipment

MODEL: Resilmount A237R Wall and Ceiling Clip or A237 Wall and Ceiling Clip

Install clips with a max. spacing of 24 in. oc perpendicular to the furring channels (Item 3). Install clips a max. spacing of 48 in. oc parallel to the furring channels (Item 3). Secure clips to the underside of the wood joists (Item 1C) using No. 8 x 1-1/4 in. wood screw. At all horizontal (short dimension) butt joints of the gypsum boards (Item 5), install clips a min. 3 in. on either side of the butt joints.

3. **FURRING CHANNEL:** Install 2-1/2 in. wide x 1 in. deep (1/2 in. leg) "hat shaped" channels perpendicular to the wood joists (Item 1C). Secure "hat shaped" channels to Resilmount A237R Wall and Ceiling Clip or A237 Wall and Ceiling Clip (Item 2).
4. **INSULATION:** Install nominal 3-5/8 in. thick unfaced fiberglass insulation with a min. R value of 13 when tested in accordance with ASTM C518. Install insulation to fill the plenum cavity and draped over the furring channel (Item 3).

5. **GYPSUM BOARD:** Install two layers of 5/8 in. Type C gypsum board as described below. After gypsum board is attached, apply vinyl or casein, dry or premixed joint compound to face layers of gypsum board in two coats to all exposed screw heads and gypsum board butt joints. Embed a min. 2 in. wide paper, plastic, or fiberglass tape in first layer of compound over butt joints of the gypsum board. Install board with the following specifications:

- i. **BASE LAYER:** Install base layer perpendicular to furring channel (Item 3) using No. 6 coarse threaded bugle head dry wall screws spaced 8 in. oc in the perimeter and in the field.
- ii. **FACE LAYER:** Install face layer perpendicular to base layer using No. 6 coarse threaded bugle head dry wall screws spaced 8 in. oc in the perimeter and in the field, and offset 4 in. from the base layer attachment pattern.