

Design Number FRPS/FME 60-05
Roof / Ceiling Assembly
Fire Rated Product Specialties Corp
FN-Z-12-20-9 Fire Rated Enclosure
ASTM E119-2012 & CAN/ULC S101
Fire Resistance Rating – 1 hour
Superimposed Load – None

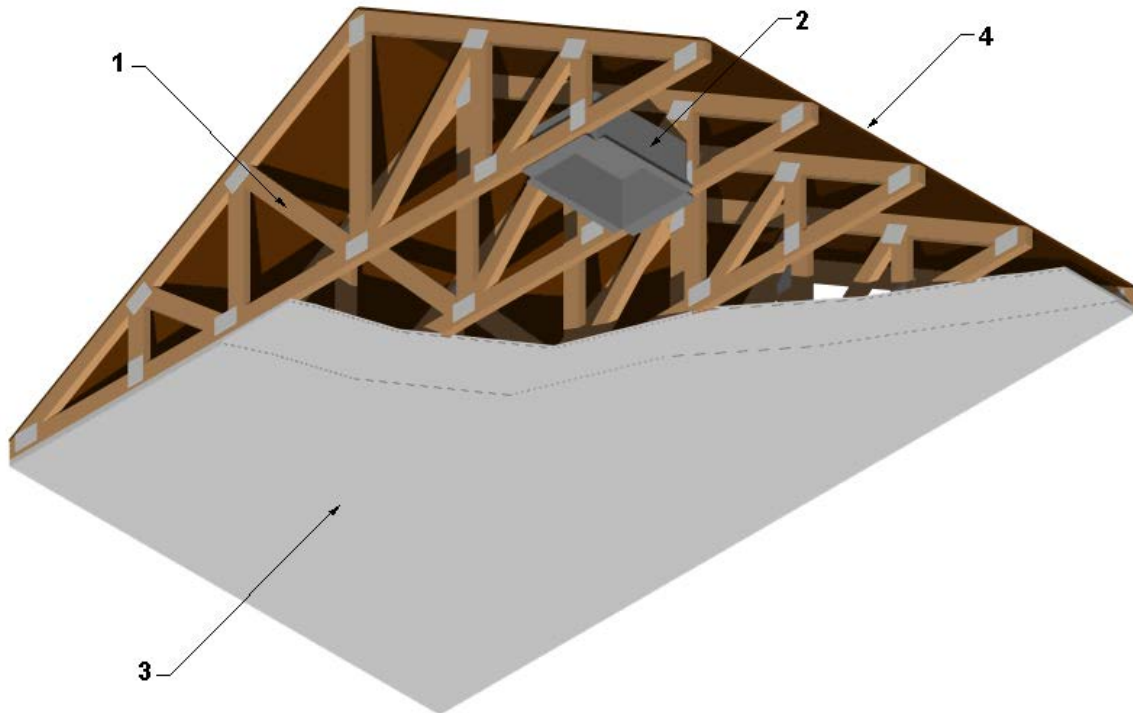

1. **WOOD TRUSS:** Install pitched or parallel chord wood trusses, spaced 24 in. on center (oc), fabricated from nominal 2 in. by 4 in. lumber, with lumber oriented vertically or horizontally. Secure truss members together with No. 20 MSG truss connector plates.

2. **CERTIFIED COMPANY:** Fire Rated Product Specialties Corporation

CERTIFIED PRODUCT: Recessed Light Cover

CERTIFIED MODEL: FN-Z-12-20-9

RECESSED LIGHT COVER: Install 22-4 GA galvanized steel, nominal 20 in. long x 12 in. wide x 9-1/2 in. deep enclosure with 2-1/2 in. wide flanges. Position the box inverted and recessed into the roof cavity. Secure the flanges

of the box to the underside of the wood truss (Item 1) with No. 6, 1-1/4 in. long bugle head screws spaced at pre-drilled locations on the flanges. The boxes may be installed in the roof with the following provisions:

- Maximum 2 fixtures within 36 sq. ft. area.
 - Minimum oc fixture spacing of 24 in. within same truss cavity.
 - Minimum center-to-center fixture spacing of 34 in. for adjacent truss cavities.
3. **GYPSUM BOARD:** Install two layers of 5/8 in. thick Type X Gypsum Board to the underside of the wood trusses (Item 1). Install base layer perpendicular to wood trusses (Item 1) and attach using 1-1/4 in. long Type W or Type S drywall screws spaced 24 in. oc. Secure face

Division 05 – Metals

05 58 00 - Formed Metal Fabrications

05 58 16 Formed Metal Enclosures

layer perpendicular to wood trusses (Item 1) offset 24 in. from base layer joints and attached using 1-7/8 in. Type W or S drywall screws spaced 12 in. OC at joints and intermediate trusses. After installation of face layer, install 1-1/2 in. Type G drywall screws spaced 12 in. oc, placed 2 in. back on either side of the end joints. After face layer of gypsum board is attached, apply vinyl or casein, dry or premixed joint compound to the exposed face of gypsum wallboard in

Page 2 of 2

two coats to all exposed fastener heads and gypsum wallboard joints. Embed a minimum 2 in. wide paper, plastic, or fiberglass tape in first layer of compound over joints in gypsum wallboard.

4. WOOD STRUCTURAL PANELS: Install 1/2 in. thick grade C-D or sheathing wood structural panels perpendicular to the wood trusses (Item 1) using 6d ring shank nails spaced maximum 12 in. oc.