

CastleRock Building Products, Inc.
Design No. CRB/BI 30-01
Thermal Insulation
ICAP Cladding
NFPA 285
Rating: Meets the Requirements

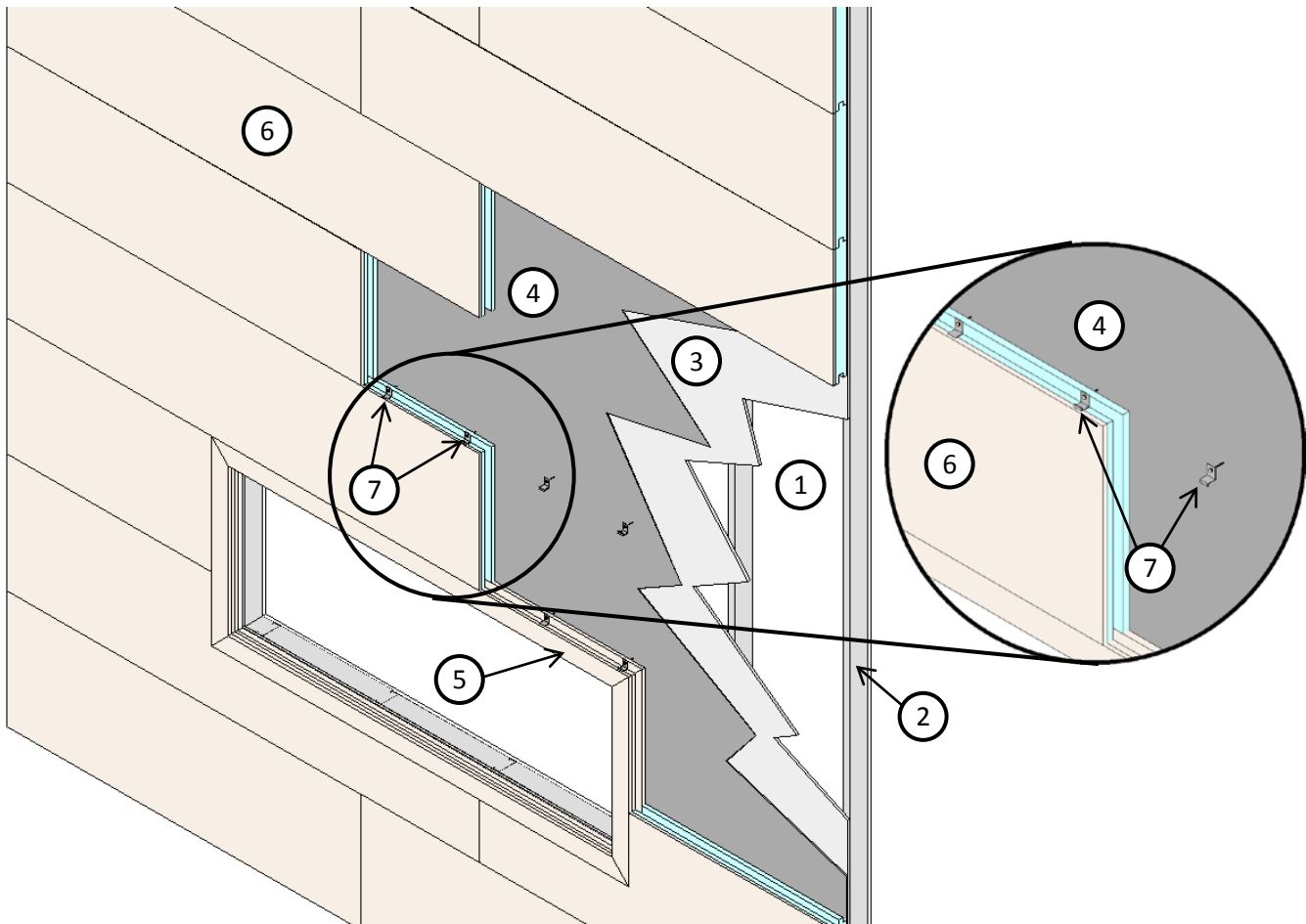

- 1. INTERIOR CLADDING:** Install one layer of 4 ft. × 10 ft. × 5/8 in. thick Type X gypsum board installed with the long dimension perpendicular to the studs (Item 2). Fasten wallboard to the studs using #6 × 1-1/4 in. self-drilling, zinc-plated bugle-head screws spaced 8 in. on center (oc) around the perimeter and 12 in. oc in the field. Apply a Level 2 finish to all joints and fasteners.
- 2. FRAMING MEMBERS:** Install 3-5/8 in., nominal 20 GA galvanized steel studs, 24 in. oc, secured with #8 × 1/2 in. long, modified truss-head framing screws to 20 GA top and bottom track.
- 3. EXTERIOR CLADDING:** Install one layer of 4 ft. × 8 ft. × 1/2 in. thick Extremegreen Magnesium Oxide (MgO) Board with the long dimension perpendicular to the studs (Item 2) and fasten with #10 × 2-1/4 in. Simpson CBSDQ self-



drilling CFS screws spaced 8 in. oc around the perimeter and in the field.

4. **WEATHER RESISTIVE BARRIER:** One layer of either of the following weather resistive barriers (WRB) installed in accordance with the manufacturer's specifications:

- A. Tremco® EXOAir WRB
- B. Sto Gold Coat WRB
- C. Masterwall Rollershield WRB

5. **CERTIFIED MANUFACTURER:** CastleRock Building Products, Inc.

CERTIFIED PRODUCT: Window Trim

CERTIFIED MODEL: ICAP Cladding Window Trim

Install max. 2-3/4 in. thick window trim composed of a number of layers of Extremegreen MgO board installed around the window opening using #9 × 3 in., Type 17 point fasteners spaced 16 in. oc to the MgO exterior cladding (Item 3). Corners can either be mitered as shown or horizontal seams can be used (not shown). Use Dow 1199 sealant at mitered or horizontal joints.

6. **CERTIFIED MANUFACTURER:** CastleRock Building Products, Inc.

CERTIFIED PRODUCT: Thermal Insulation

CERTIFIED MODEL: ICAP Cladding

ICAP Cladding containing max. 2-1/4 in. EPS ATM C578 Type XV foam sheathed with 1/2 in. Extremegreen MgO board adhered to the exterior face. Secure panels to exterior cladding (Item 3) using Type 17 point fasteners screws and washers through top of panel 16 in. oc. For panels directly above the window panel, clips (Item 7) are used. All panels must be installed with vertical seams staggered. The panels above the window must have the vertical seams staggered min. two-thirds of the window's width above the window opening. All joints up to 96 in. above the window area are to be sealed using Dow 790 sealant.

7. **PANEL CLIPS:** Secure ICAP Cladding (Item 6) above the window area using aluminum or stainless steel J- and Z-clips. Using the Type 17 point fasteners, secure the panels with alternating J- (1 in. wide with 2-1/4 in. long leg, 1 in. long leg, and 1/4 in. long leg) and Z-clips (1 in. wide with 2-1/4 in. long leg, 1 in. long leg, and 1/4 in. long leg) each spaced 24 in. oc.