

Design No. CC / CA 120-01 COLUMN
Carboline Company (Formerly Nu-Chem, Inc.) Fire-Sorb 1001 ASTM E119-98 Assembly Rating – 2 hr. or less

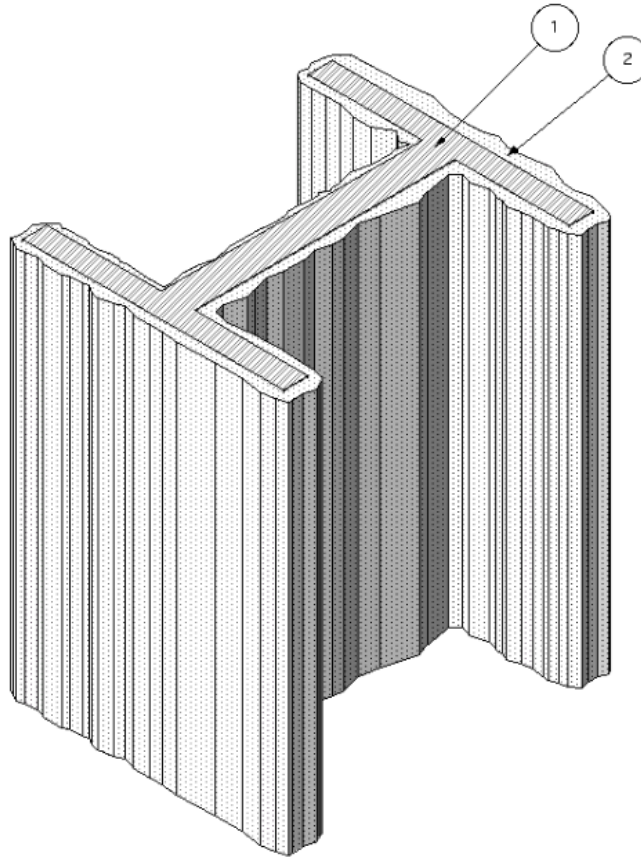

1. STEEL COLUMN: W-Shaped.
2. FIRE-RESISTIVE COATING: Spray or paint in one or more coats according to the manufacturer's instructions. Thickness determined by table for desired rating and column.

Listed Manufacturer:

*Carboline Company –
High-Performance Coatings
High-Performance Coating Systems
Fire-Sorb 1001*

Design No. CC / CA 120-01									
Hp/A	W/D	30 min.		60 min		90 min.		120 min.	
1/m	lb./ft/in	mm	in	mm	in	mm	in	mm	in
45	2.93	0.74	0.029	0.74	0.029	0.84	0.033	1.18	0.046
50	2.64	0.74	0.029	0.74	0.029	0.92	0.036	1.29	0.051
60	2.2	0.74	0.029	0.74	0.029	1.07	0.042	1.5	0.059
70	1.89	0.74	0.029	0.74	0.029	1.21	0.048	1.69	0.067
80	1.65	0.74	0.029	0.8	0.032	1.34	0.053	1.88	0.074
90	1.47	0.74	0.029	0.88	0.035	1.47	0.058		
100	1.32	0.74	0.029	0.95	0.037	1.61	0.063		
110	1.2	0.74	0.029	1.01	0.04	1.74	0.068		
120	1.1	0.74	0.029	1.08	0.042	1.87	0.074		
130	1.02	0.74	0.029	1.14	0.045	2	0.079		
140	0.94	0.74	0.029	1.19	0.047	2.14	0.084		
150	0.88	0.74	0.029	1.25	0.049	2.27	0.089		
160	0.83	0.74	0.029	1.3	0.051	2.4	0.095		
162	0.82	0.74	0.029	1.31	0.051	2.42	0.095		