

**CENTRIA**  
**Design Number CSG/CWP 30-02**  
**Non-Load Bearing Wall System**  
**TotalClad and TotalCad Xrib Insulated Panels**  
**CAN/ULC S 134 (1992)**

**Meets the Requirements of Section 3.1.5.5 of the National Building Code of Canada, 2010**

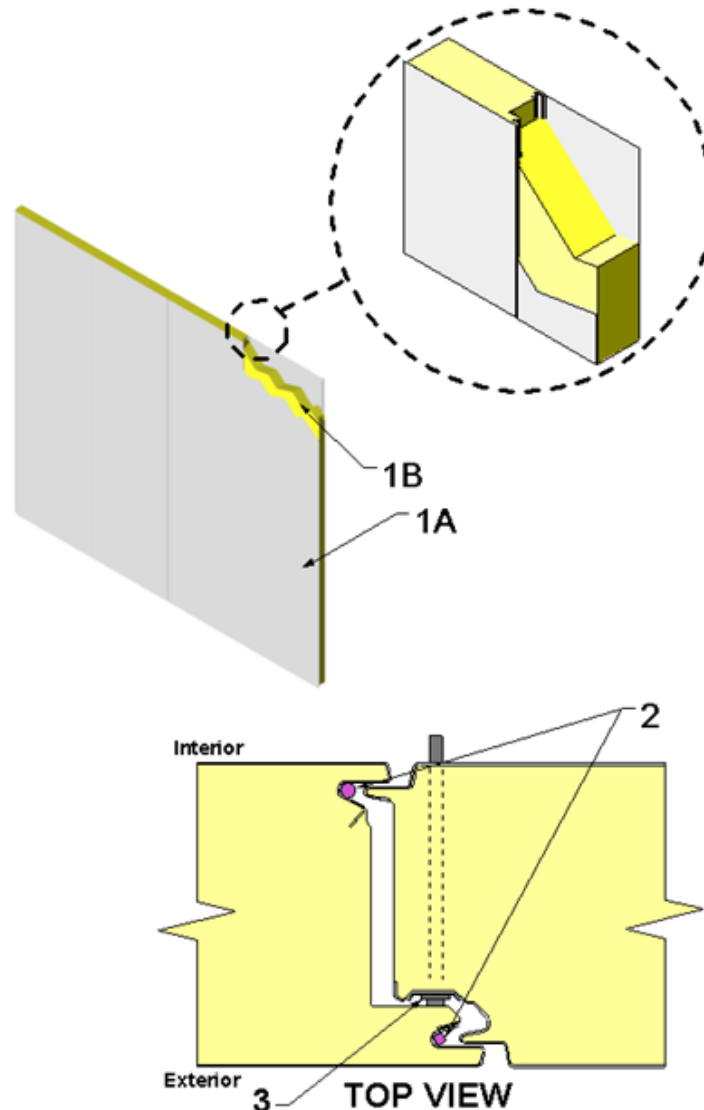

**1. CERTIFIED COMPANY: CENTRIA**

**CERTIFIED PRODUCT:** Wall Panels

**MODEL:** TotalClad Insulated Metal Panels  
and TotalClad Xrib Insulated Metal Panels  
(not shown)

**INSULATED WALL PANELS:** Construct wall of panels measuring nominal 12 to 44-1/2 in. wide. Min. thickness of the TotalClad Insulated Metal Panels is 2 in. and TotalClad Xrib is 1-1/2 in. Max. approved thickness of 6 in. Install panels with the longitudinal (long dimension) edges placed horizontally or vertically. Construct wall panels of the following materials:

- A. **PANEL FACING** – Construct interior and exterior faces of min. 26 GA galvanized or zinc/aluminum alloy coated steel with painted or mill finish, or min. 26 GA stainless steel with mill finish. Panel faces are roll formed with a smooth (no profile) or corrugated profile.
- B. **POLYURETHANE FOAM CORE** – Fill hollow core between panel faces (Item 1A) with nominal 2.17 pcf density polyurethane foam forming the male and female mating edges of the panels.

**2. SIDE JOINT SEALANT (Optional):**

- A. **TOTALCLAD INSULATED METAL PANEL** – Install a nominal 3/16 in. bead of one-component, urethane or butyl sealant to the female edge of the panel on either the exterior, interior, or both sides prior to joining the insulated wall panels (Item 1A).
- B. **TOTALCLAD XRIB INSULATED METAL PANEL** – Install a nominal 3/16 in. bead of one-component, urethane or butyl sealant to the female edge of the panel on the interior side prior to joining the insulated wall panels (Item 1). Install butyl tape sealant for the exterior lap joint.

**3. FASTENERS:** Install fasteners according to panel type.

- A. **TOTALCLAD PANELS** – Install two #14 or 1/4 in. diameter hex-head screws through 7/8 in. wide x 4 in. long concealed panel clips within the side joints of the insulated wall panel (Item 1). The screws shall be of sufficient length so as to properly engage the wall support member. Install clips at each wall support member.
- B. **TOTALCLAD XRIB PANEL (Not Shown)** – Install #14 or 1/4 in. diameter x 7/8 in. Lap Tek screws at a min. of 20 in. on center (oc) through the panel overlap at the exterior side joint. Install #14 or 1/4 in. diameter screws through wall panel at 12 in. oc between the major panel ribs to secure the panel to wall support member. The screws shall be of sufficient length so as to properly engage the wall support member. Fasteners shall be used at all wall support members.