



Intense Lighting, a Leviton Company
Design No. INT/LI 120-02
Floor/Ceiling Assembly
Recessed Luminaire
LC4 Series 4-in. Fundamentals™
ASTM E119, UL 263
Fire Resistance Rating: Maximum 2 Hour

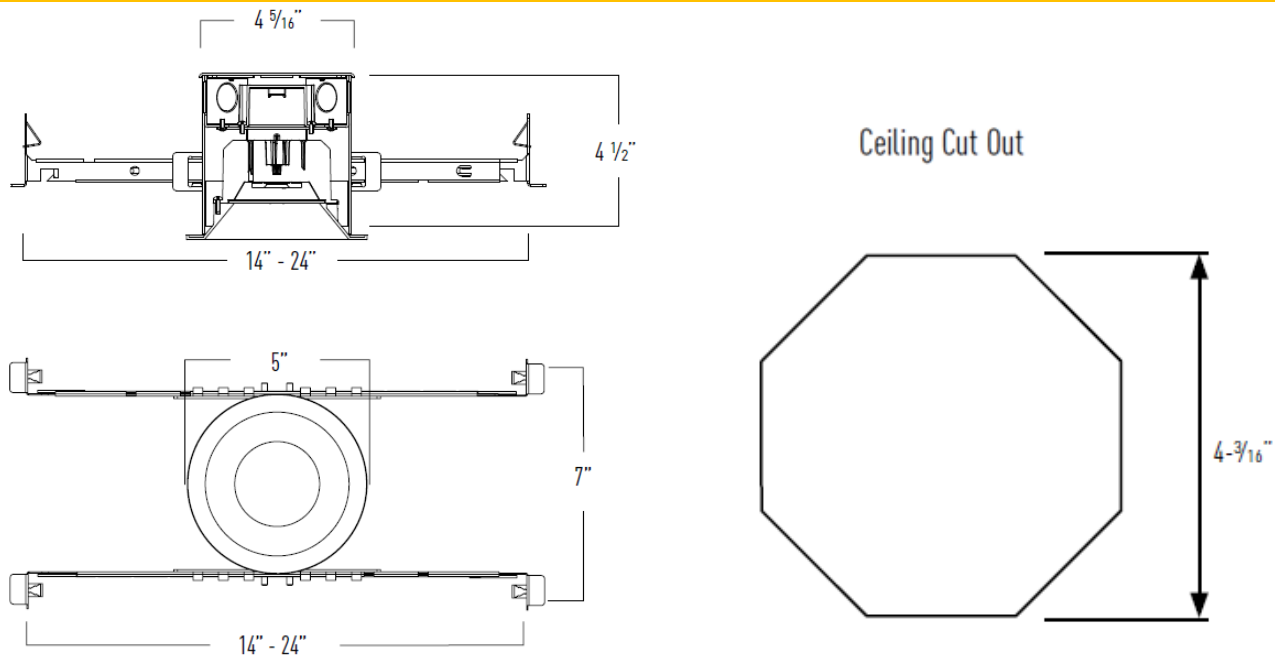

Figure 1. LC4 Series 4-in. Fundamentals™

- 1. HORIZONTAL ASSEMBLY:** Use a maximum two hour fire-rated horizontal assembly with max. 2 in. deep gypsum ceiling membrane and constructed in accordance with the listed design or approved prescribed design.
- 2. CERTIFIED MANUFACTURER:** Intense Lighting, a Leviton Company

CERTIFIED PRODUCT: Recessed Luminaire

CERTIFIED MODEL: LC4 Series 4-in. Fundamentals™

Approved for use with ETL-Certified LCT4 Series Trim.

Follow the manufacturer's installation instructions. Cut a 4-3/16 in. octagonal opening in the gypsum ceiling such that the annular space between the ceiling membrane and the box does not exceed 1/8 in. Use the standard bar hanger configuration (see Figure 1) for ceiling membranes up to 1-1/2 in. deep. When required, rotate bar hangers 180° per manufacturer's installation instructions for ceiling membranes up to 2 in. deep. Ensure penetrations do not exceed 100 square inches in any 100 square feet of ceiling area. Install with a min. separation of 3 ft between units.

Consult the listing report on the Directory of Building Products (<https://bpdirectory.intertek.com>) for the edition of the standard(s) evaluated