

**Rectorseal, LLC**  
**Design No. RSC/JF 120-01**  
**JOINT SPRAY**

**Biostop 750, Biostop 800, FlameSafe FS 3000, FlameSafe FS 4000, Metacaulk 835+ Caulk, Metacaulk 835+ SL, Metacaulk 835+ Spray, Metacaulk 1200 Spray, and Metacaulk 1500 Spray**

**ASTM E1966**  
Rating: 2 Hours  
Cycling:  $\pm 12.5\%$   
Superimposed Load: None  
**CAN/ULC S115 at 2.5 Pa**  
FTH: 2 Hours

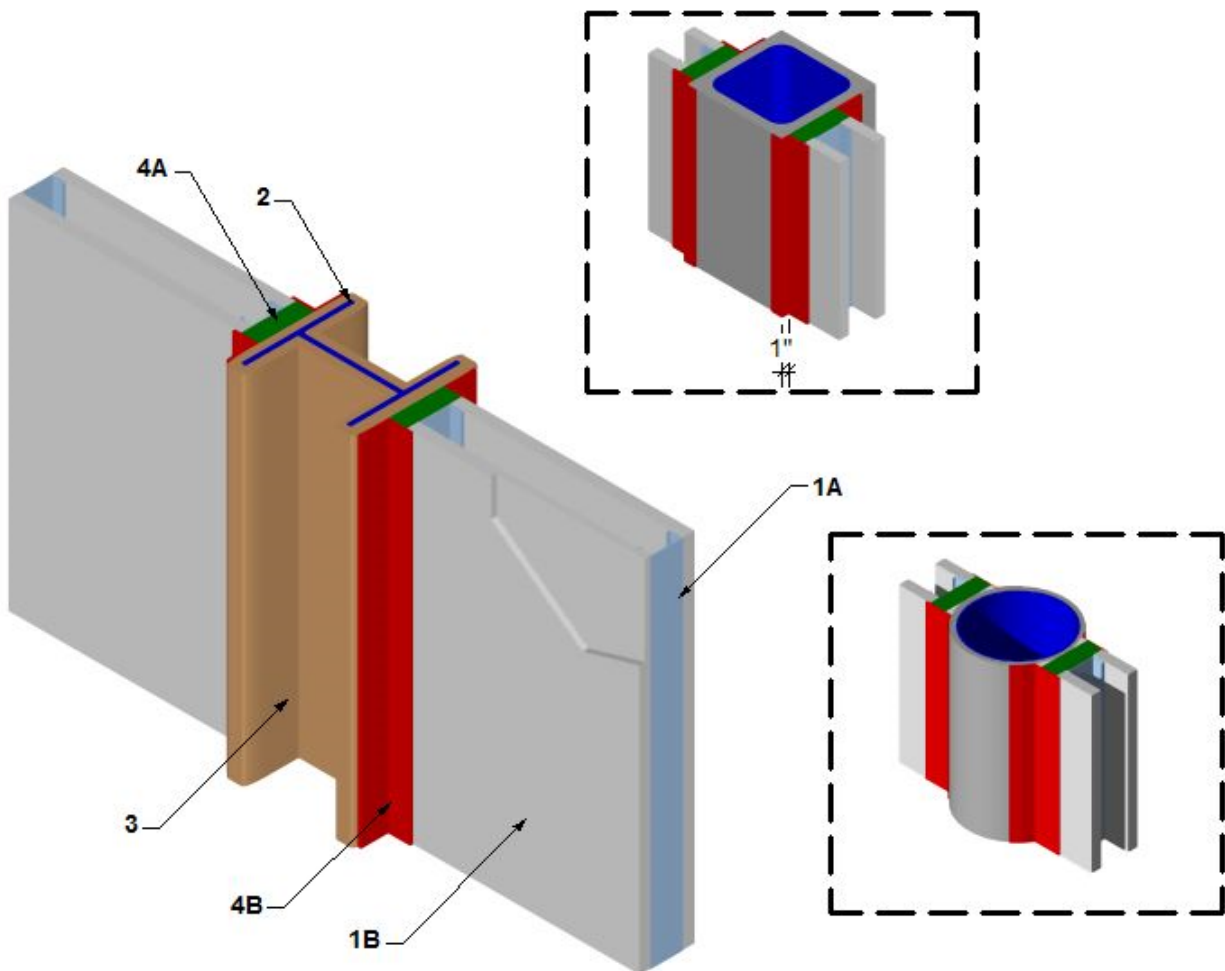



**1. GYPSUM WALL ASSEMBLY:** Construct 2-hour or 1-hour rated gypsum wall assembly containing the following elements:

- A. **STEEL STUDS:** Install min. 3-5/8 in. deep, 25 GA galvanized steel studs spaced max. 24 in. on center (oc) and floated between 3-5/8 in. deep, 25 GA top and bottom track (not shown).
- B. **GYPSUM BOARD:** Install two layers of 5/8 in. Type X gypsum board to both sides of wall assembly installed with the long dimension parallel to the steel studs. Secure base layer to steel studs using 1 in. long Type S self-drilling screws spaced 16 in. oc around the perimeter and 16 in. oc in the field. Install face layer with joints offset 24 in. from the base layer and secured using 1-5/8 in. long Type S self-drilling screws spaced 16 in. oc around the perimeter and 16 oc in the field, staggered 8 in. from the base layer fasteners.
- C. **JOINT TAPE AND COMPOUND (Not Shown):** Apply a level 2 finish of vinyl or casein, dry or premixed, joint compound as follows. Apply to gypsum board in two coats to all exposed fastener heads and gypsum board joints. Embed min. 2 in. wide paper, plastic, or fiberglass tape in first layer of compound over joints in gypsum board.

**2. COLUMN:** Install min. 8 in. (width and depth, or diameter) wide flange shape, rectangular hollow structural steel (HSS) or circular HSS column in accordance with the applicable Building Code requirements. Install wide flange shape or rectangular HSS column centered or offset against the gypsum wall assembly. For HSS column, install

circular centered against the gypsum wall assembly. When column is offset, maintain min. 1 in. separation from column edge to the fire resistive joint system and gypsum wall assembly.

**3. FIREPROOF COATING:** Apply Grace Construction Products Monokote MK-6/HY Fireproofing to the column per the manufacturer's installation instructions to maintain a min. 2-hour fire resistance rating.

**4. FIRE RESISTIVE JOINT SYSTEM:** Install fire resistive joint system between gypsum wall assembly and column containing the following elements. Maintain max. joint width of 1-1/2 in.

- A. **PACKING MATERIAL:** Install 4 pcf density mineral fiber insulation bearing the Intertek Certification Mark, compressed 50% in the joint opening flush with surface of wall. For installation against circular HSS column, maintain the min. compression across the entire depth of the joint system. Trim excess insulation at gypsum wall assembly faces.
- B. **JOINT SEALANT:** Rectorseal, LLC Biostop 750, Biostop 800, FlameSafe FS 3000, FlameSafe FS 4000, Metacaulk 835+ Caulk, Metacaulk 835+ SL, Metacaulk 835+ Spray, Metacaulk 1200 Spray, and Metacaulk 1500 Spray

**FILL, VOID, OR CAVITY MATERIAL:** Apply min. 1/8 in. (wet film thickness) thick layer of fill material over fire resistive joint system ensuring min. 2 in. overlap onto fireproof coating and min. 1/2 in. onto face of gypsum wall assembly.

Consult the listing report on the Directory of Building Products (<https://bpdirectory.intertek.com>) for the edition of the standard(s) evaluated.

*Compliance of the assembly described in this Design Listing with the referenced standard relies on verification that the assembly constructed in the field is consistent with that described herein. Intertek certified products may be verified by the approved Intertek label; other products must be verified by the Authority Having Jurisdiction as meeting the specifications stated herein.*