

**All Weather Insulated Panels
Design No. AWIP/FWPA 60-02
Non-loadbearing Fire Rated Wall Assembly
AWIP fiRe Panel Wall Assembly
Vertical Symmetric Wall Assembly
ASTM E119 and CAN/ULC S101
Rating: 1 Hour**

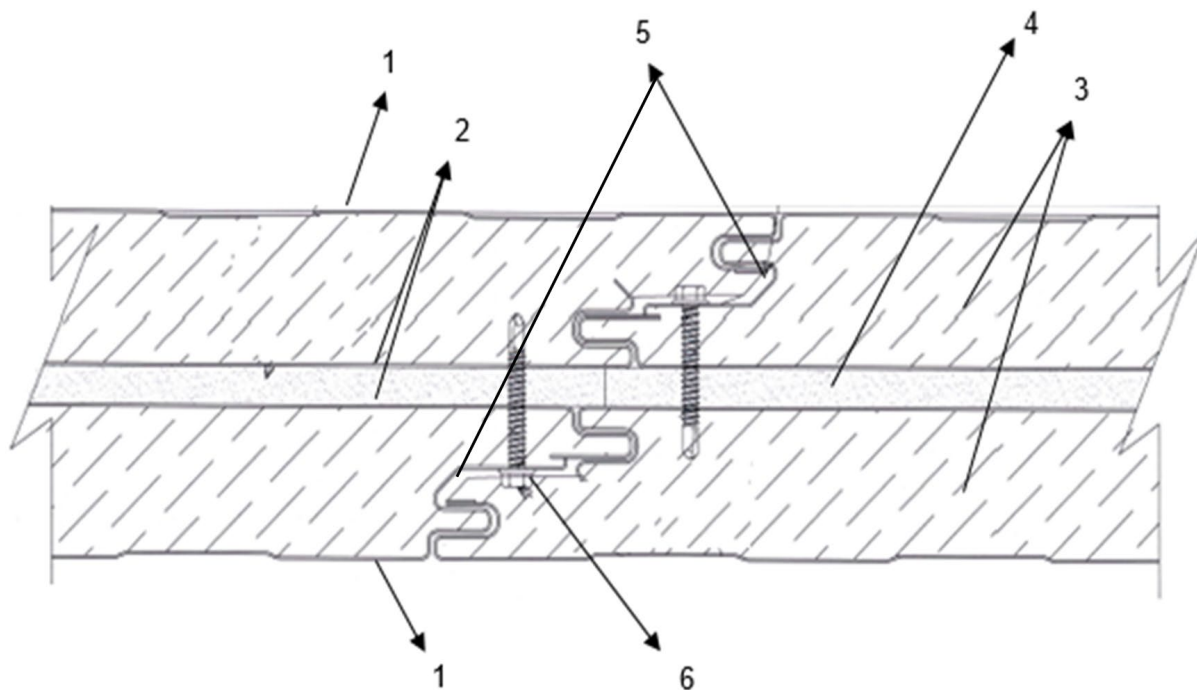

Overall fiRe Panel Thickness	Panel Thickness per Side	Fastener Length (see Item 5)
4.5 in.	2.0 in.	2 in.
5.5 in.	2.5 in.	2.5 in. or 3 in.*
6.5 in.	3.0 in.	3 in.

**Depending on the thickness of that side's panel*
AWIP fiRe Panels are factory fabricated

- 1. EXTERNAL STEEL FACING:** The facing skins of the AWIP fiRe Panel are composed of min. 26 GA galvanized steel, ASTM A653, Grade 33 G90. This steel facing may be embossed or finished with different patterns and textures, including DM40-F, FL40-F, HE40-F, HE40A-F, ST40-F, MV40-F, and FW40-F.
- 2. INTERNAL STEEL SKINS:** The center skin is composed of 26 GA coated steel (55% Aluminum-Zinc Alloy coated with AZ50) ASTM A792, CS Type B.



3. **INSULATION:** The core consists of a medium density, two-part polyurethane foam of proprietary formulation. Thickness of the foam depends on the overall panel thickness (See Table above).
4. **GYPSON BOARD:** One layer of 1/2 in. thick Pabco Gypsum Super C Gypsum board or one layer of 5/8 in. thick Pabco Type C Gypsum board.
5. **SEALANT:** 1/2 in. bead of Rutland 500-Degree RTV Sealant applied to the joints on both sides of the panel.
6. **JOINT FASTENERS:** 1/4 in. - 14 HWH Self Driller Zinc Plated Screws. Alternatively, #14–13 TEK 3 fasteners with low profile heads may be used. Fasteners may be 2 in. to 3 in. long depending on panel thickness. Joint fasteners are located 6 in. from top and bottom, and 12 in. on center (oc).
7. **STEEL C-CHANNEL (Not Shown):** The AWIP fiRe Panels are held in place at the top, bottom, and sides by 26 GA steel C-channel with 2-1/2 in. legs. The panels are fastened into C-channels using 6 in. Tek screws penetrating the full wall thickness, with fasteners spaced every 12 in.

along the perimeter of the panels. The size of the C-channel may vary depending on the panel thickness.

8. **INTERMEDIATE SUPPORTS (Optional, not required for fire resistance, and not shown):** Where panel walls require additional support for project specific reasons, intermediate steel supports may be installed in accordance with manufacturer's instructions on the panel span between the end panel support connections, using #14 self-drilling or self-tapping screws having sufficient length to extend from the hidden clip placement point under the exterior formed edge of the panel, completely into the support steel on the opposite side, or #10 FabLok rivets. Spacing is determined by project requirements.
9. **EXTERIOR CLADDING AND ACCESSORIES (Optional, not shown):** Any single layered noncombustible cladding, of any thickness and profile, may be fastened to steel hat channels that are fastened to either face of the wall assembly along the joints. The fastener type and spacing are job specific parameters and will vary depending on the wind load requirement.

Consult the listing report on the Directory of Building Products (<https://bpdirectory.intertek.com>) for the edition of the standard(s) evaluated.

Compliance of the assembly described in this Design Listing with the referenced standard relies on verification that the assembly constructed in the field is consistent with that described herein. Intertek certified products may be verified by the approved Intertek label; other products must be verified by the Authority Having Jurisdiction as meeting the specifications stated herein.