

---

**GP Gypsum**  
**Design No. GP/GBA 120-02**  
**Horizontal Shaftwall Gypsum Board**  
**DensGlass® Shaftliner and ToughRock® Shaftliner**  
**ASTM E119, CAN/ULC S101**  
**Rating: 2 Hour Restrained, Non-Loadbearing**

---

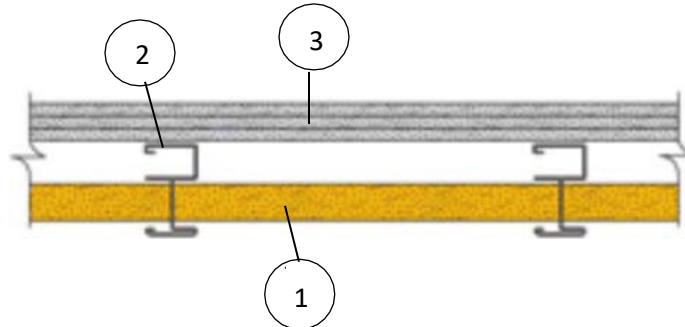

- 1. CERTIFIED MANUFACTURER:** Georgia Pacific Gypsum, LLC.

**CERTIFIED PRODUCT:** DensGlass® Shaftliner and ToughRock® Shaftliner

**GYPSUM SHAFTLINER:** 1 in. thick DensGlass® Shaftliner or ToughRock® Shaftliner Type X panels, supplied in nominal 24 in. widths. The panels are inserted against the long leg of the 'J' runners and into the 1 in. deep recess of the C-T studs. Edges or ends of panels are retained by binding 'J' runner tabs (12 in. on center ( oc)) at a 90° angle or by using the Optional Item.

**GYPSUM SHAFTLINER (Optional):** Optional end or edge detail, using 3 in. min. width × 1 in. thick DensGlass® Shaftliner or 1 in. thick ToughRock® Shaftliner over openings up to 1-1/4 in. wide, and fastened with 1-1/4 in. drywall screws 12 in. oc max. to long leg of 'J' runner. This optional detail may be used instead of bending the 'J' runner tabs.

- 2. STEEL STUD:** 'C-T' shaped slotted web studs, 1-1/2 in. wide × 2-1/2 in. min. deep, fabricated from min. 0.018 in. (25 GA) thick galvanized steel. Friction filled 24 in. oc max. with 'J' runner flanges. Cut studs 1/2 in. less than the span between 'J' runner webs at the ends and fit between panels of Shaftliner.
- 3. GYPSUM BOARD:** 1/2 in. thick ToughRock® Fireguard C gypsum board or 1/2 in. thick DensArmor® Fireguard C gypsum panels, applied in three layers, with each layer applied parallel or perpendicular to studs, and with edge joints offset 16 in. between layers. Base layer attached with 1 in. drywall screws 12 in. oc. Middle layer attached with 1-5/8 in. drywall screws 12 in. oc. Face layer attached to framing with 2 in. drywall screws 12 in. oc, plus 2 in. drywall screws at 1 in. and 6 in. from edge joints, plus 1-1/2 in. #10 Type G screws 8 in. oc at 3 in. from butt joints. Butt joints are centered on stud flanges and are offset to different studs between adjoining panels and between layers. Face layer joints are taped and finished.



4. **PERIMETER FRAMING (Not Shown):** 'J' shaped runner with unequal legs, 2-1/2 in. min. deep, fabricated from min. 20 GA galvanized steel. Secured around the perimeter with suitable fasteners, 24 in. oc max.

*Consult the listing report on the Directory of Building Products (<https://bpdirectory.intertek.com>) for the edition of the standard(s) evaluated.*

*Compliance of the assembly described in this Design Listing with the referenced standard relies on verification that the assembly constructed in the field is consistent with that described herein. Intertek certified products may be verified by the approved Intertek label; other products must be verified by the Authority Having Jurisdiction as meeting the specifications stated herein.*