

DESIGN NO. 3M/PV 120-08
VERTICAL (WALL); RATINGS: SEE TABLE BELOW
TEST PRESSURE DIFFERENTIAL - 2.5 PA (0.01" OF WATER) MINIMUM

Penetrating Items	Max. Pipe Size (mm)*	Max. Hole Size (mm)*	Min.-Max. Annular Spacing (mm)*	RATINGS			
				CAN/ULC-S115		ASTM-E814	
				F, FH	FTH	F	FT
Conduit	100	150	6 - 38	2 Hr	15 Min	2 Hr	15 Min
Copper	100	150	6 - 45	2 Hr	15 Min	2 Hr	15 Min
CPVC**	50	100	6 - 32	2 Hr	2 Hr	2 Hr	2 Hr
PVC**	50	100	3 - 6	2 Hr	2 Hr	2 Hr	2 Hr
Steel/Cast	200	55	0 - 38	2 Hr	15 Min	2 Hr	15 Min
BX	12.5	25	6 - 19	2 Hr	0 Min	2 Hr	0 Min
Elec. XX	45% Fill	100	0 - 64	2 Hr	30 Min	2 Hr	30 Min
Kitec	1-3/16"	2"	1/2" - 3/4"	2 Hr	2 Hr	2 Hr	2 Hr

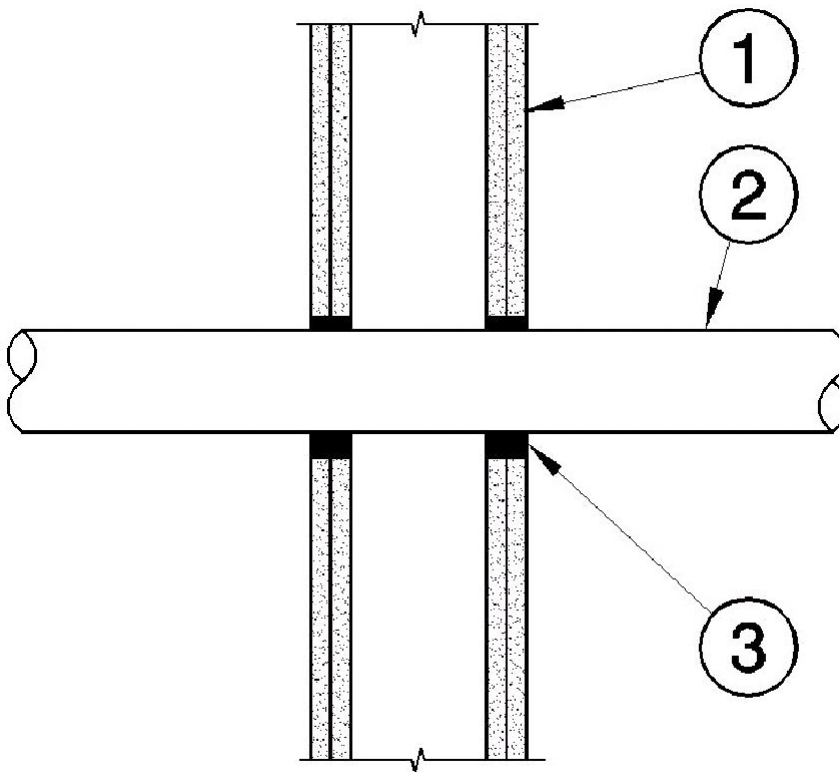

1. **Wall Assembly:** 1 hour or 2 hour rated wood or steel stud framed gypsum wall assembly. Minimum wall thickness: 114mm (4-1/2") for 1 hour rated walls, 140mm (5-1/2") for 2 hour rated walls. The hourly F rating of the firestop system

	is equal to the hourly fire rating of the wall assembly in which it is installed.
2.	Penetrating Items: Metallic and non-metallic pipe and conduit as described in the table of ratings.
3.	Firestop Sealant: 3M™ Fire Barrier 1000 Silicone Sealant No Sag or 3M™ Fire Barrier IC 15WB+ applied to the full depth of the gypsum wallboard membrane on both sides of the wall. For point contact penetrations, a 12.5mm (1/2") surface bead is required at point of contact location. For Kitec use only 3M™ Fire Barrier IC 15WB+ applied the full depth of the gypsum wallboard membrane on both sides of the wall.

*To convert mm to inches, divide by 25.4.

**Process & Supply only in Canada