

---

**Knauf, LLC**  
**Design Number KL/GBF 60-02**  
**Non-Load Bearing Wall Assembly**  
**Knauf Fire Resistant Gypsum Board**  
**ASTM E119**  
**Fire Resistance Rating: 1 hr**

---

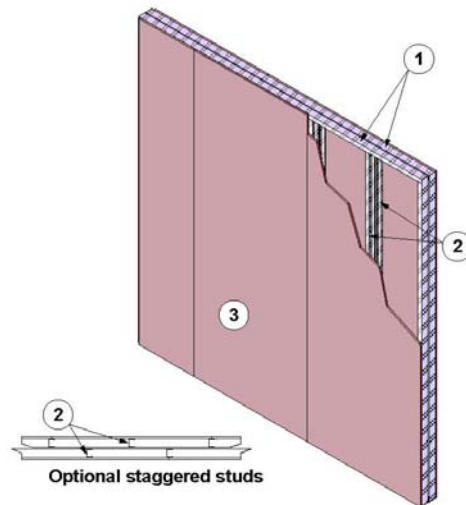

1. CERTIFIED COMPANY: Knauf, LLC.

CERTIFIED PRODUCT: Steel framing member

MODEL: UW 64/25/0.9/3200

STEEL TRACK: Install two rows of min. 2-1/2 in. (65mm) deep, 20 GA (1mm) Knauf UW shallow galvanized track to the existing floor, ceiling or wall assemblies using appropriate fasteners for the existing construction. Space the two rows of tracks a min. 0.4 in. (10mm) apart.

2. CERTIFIED COMPANY: Knauf, LLC.

CERTIFIED PRODUCT: Steel framing member

MODEL: CW 64/33/0.9/3000

STEEL STUDS: Friction fit two rows of min. 2-1/2 in. (64mm) deep, 20 GA (1mm) Knauf CW galvanized steel studs into top and bottom steel tracks (Item 1) spaced max. 24

in. (610mm) on center (oc). Studs cut to be nominal 3mm shorter than the wall height. Studs can be installed inline or offset.

3. CERTIFIED COMPANY: Knauf, LLC.

CERTIFIED PRODUCT: Type X Gypsum Board

MODEL: Knauf GW-TX

GYPSUM BOARD: Install one layer of 5/8 in. (15.9mm) Knauf GW-TX Type X gypsum board to the face steel studs (Item 2) to each side of the wall installed with the long edge vertical with joints offset min. 12 in. (305mm) on opposing sides of the wall. Install gypsum board using Knauf Self-Drilling TN 3.5x25 screws spaced 12 in. (305mm) oc. Attach gypsum board to steel studs only. Gypsum board not attached to steel track (Item 1).

4. CERTIFIED COMPANY: Knauf, LLC.

**Division 09 Finishes**  
**09 29 00 Gypsum Board**  
**09 29 82 Gypsum Board Fireproofing**

**Page 2 of 2**

CERTIFIED PRODUCT: Joint Compound

MODEL: Readygips Multi-Purpose Joint Compound

JOINT TAPE AND COMPOUND – (Not Shown) Apply a level 2 finish of self-adhering Knauf Joint tape and Knauf

Readygips multi-purpose joint compound: Apply tape to face layer of gypsum board (Item 3) at all gypsum board joints. Apply joint compound in two coats to all exposed fastener heads and gypsum board joints.