

---

Knauf, LLC  
Design Number KL/GBF 120-06  
Non-Load Bearing Wall Assembly  
Knauf Fire Resistant Gypsum Board  
ASTM E119  
Fire Resistance Rating: 2 hr

---

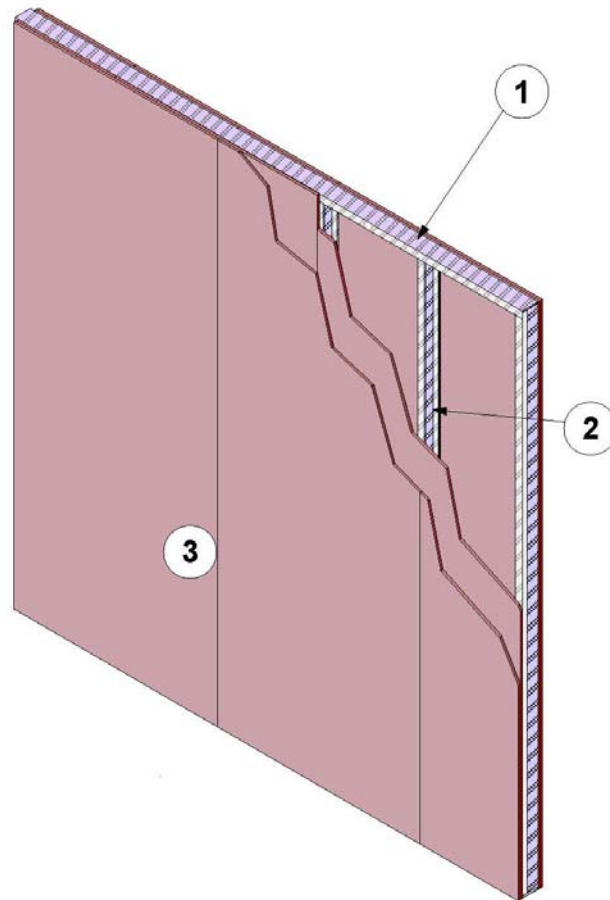

1. CERTIFIED COMPANY: Knauf, LLC.

CERTIFIED PRODUCT: Steel framing member

MODEL: Knauf UW Track

STEEL TRACK: Install min. 3-5/8 in. (92mm) deep, 26 GA (0.455mm) Knauf UW shallow galvanized track to the existing floor, ceiling or wall assemblies using appropriate fasteners for the existing construction.

2. CERTIFIED COMPANY: Knauf, LLC.

CERTIFIED PRODUCT: Steel framing member

MODEL: Knauf CW Studs

STEEL STUDS: Friction min. 3-5/8 in. (92mm) deep, 26 GA (0.455mm) Knauf CW galvanized steel studs into top and bottom steel tracks (Item 1) spaced max. 24 in. (610mm) on center (oc). Studs cut to be

nominal 3/4 in. (19mm) shorter than the wall height.

3. CERTIFIED COMPANY: Knauf, LLC.

CERTIFIED PRODUCT: Type X Gypsum Board

MODEL: Knauf GW-TX

GYPSUM BOARD: Install two layers of 1/2 in. (12.7mm) Knauf GW-TX Type X gypsum board to the face steel studs (Item 2) to each side of the wall installed with the long edge vertical with joints offset min. 12 in. (305mm) on opposing sides of the wall. Install base layer gypsum board using Knauf Self-Drilling TN 3.9x25 screws spaced 12 in. (305mm) oc. Install face layer gypsum board using

Knauf Self-Drilling TN 3.9x35 screws spaced 12 in. (305mm) oc.

4. CERTIFIED COMPANY: Knauf, LLC.

CERTIFIED PRODUCT: Joint Compound

MODEL: Readygips Multi-Purpose Joint Compound

JOINT TAPE AND COMPOUND – (Not Shown) Apply a level 2 finish of self-adhering Knauf Joint tape and Knauf Readygips Multi-Purpose Joint Compound: Apply tape to face layer of gypsum board (Item 3) at all gypsum board joints. Apply joint compound in two coats to all exposed fastener heads and gypsum board joints.