

Georgia-Pacific Gypsum, LLC
Design No. GP/WA 120-05
Non-Bearing Wall Assembly
Area Separation Wall
ASTM E119
Rating: 2 hours

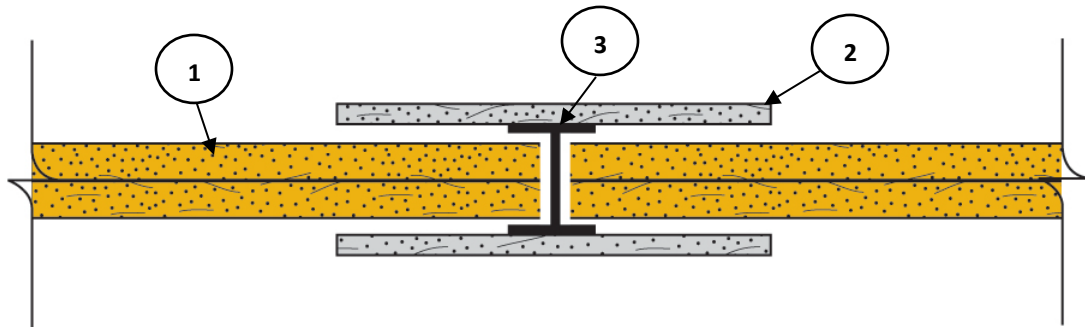

1. **CERTIFIED MANUFACTURER:** Georgia-Pacific Gypsum, LLC

CERTIFIED PRODUCT: Gypsum Shaftliner

CERTIFIED MODEL: ToughRock® Shaftliner or DensGlass® Shaftliner

Gypsum Shaftliner: Two layers 1-in. (25.4 mm) ToughRock® Shaftliner or DensGlass® Shaftliner inserted in H-Studs 24-in. (610 mm) on center (oc).

2. **Gypsum Board:** Metal studs covered using 6-in. (152 mm) wide, 1/2-in. (12.7 mm) DensArmor Plus® Fireguard® C Interior Panels, 1/2-in. (12.7

mm) ToughRock® Fireguard® C gypsum board, or 5/8-in. (15.9 mm) ToughRock® Fireguard® X gypsum board mechanically fastened to steel studs Type 'S', #6 drywall screws, 12 in. oc starting 6 in. from top or bottom. Use 1-in. long screws for 1/2-in. gypsum board, use 1-1/4-in. long screws for 5/8-in. gypsum board.

3. **Steel Studs:** 'H' shaped Studs, 1-1/2-in. (38.1 mm) wide × 2-in. (50.8 mm) deep, roll-formed from minimum 0.018-in. thick galvanized steel. Cut to length 1/2 in. less than the openings height and spaced a maximum of 24 in. (610 mm) oc