

RENco USA Inc.
Design No. RUI/WS 60-01
Load Bearing Wall System
Renco Modular Composite Block
ASTM E119 – 1 Hour
Rating: Passed – 4,133 plf

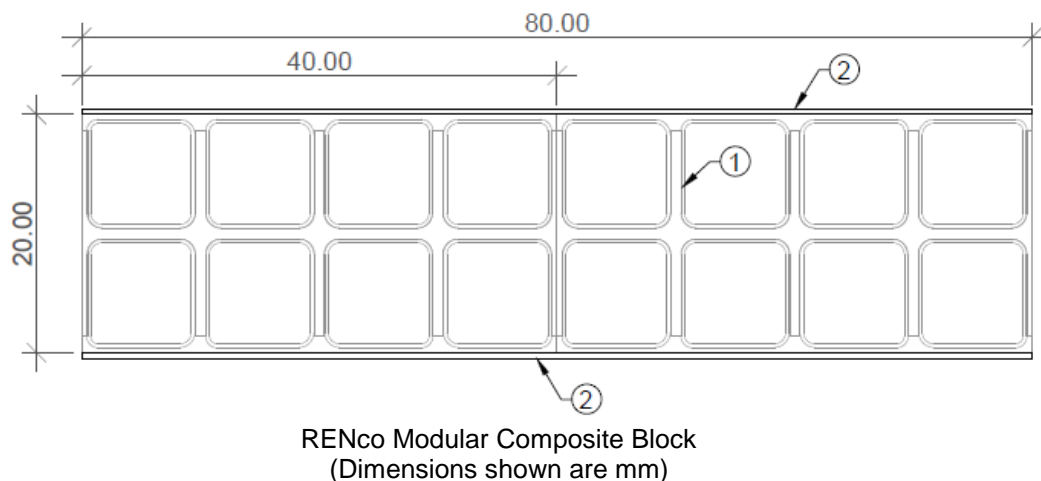

1. CERTIFIED MANUFACTURER: RENco USA Inc.

CERTIFIED PRODUCT: RENco Fiber Reinforced Composite Modular Wall System, consists of modular building blocks (shown above) stacked in a running bond pattern with each additional course adhered to the lower course with Plexus MA530 Adhesive in accordance with manufacturer's installation instructions. Max. wall height is 10 ft.

CERTIFIED MODEL: RENco Modular Composite Block

2. INTERIOR AND EXTERIOR CLADDING:
5/8 in. thick Type X gypsum board with long dimension perpendicular to horizontal joints of block. Attached to FRP block using #6 W, 1-1/4 in. long bugle-head screws 12 in. on center (oc) around perimeter and 12 in. oc in the field.

- A. **JOINT TAPE AND COMPOUND** – (Not Shown) Vinyl or casein, dry or premixed, joint compound applied to face layers of gypsum board (Item 1) in two coats to all exposed fastener heads and board joints. A min. 2 in. wide paper, plastic, or fiberglass tape is embedded in first layer of compound over joints in gypsum board.