

RENco USA Inc.
Design No. RUI/WS 120-01
Load Bearing Wall System
Renco Modular Composite Block
ASTM E119 – 2 Hour
Rating: Passed – 4,133 plf

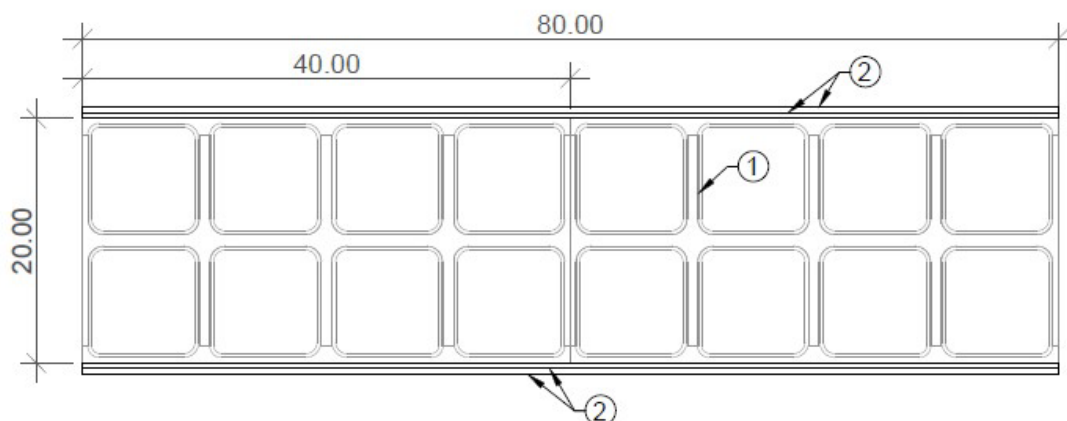

RENco Modular Composite Block
(Dimensions shown are mm)

1. CERTIFIED MANUFACTURER: RENco USA Inc.

CERTIFIED PRODUCT: RENco Fiber Reinforced Composite Modular Wall System, consists of modular building blocks (shown above) stacked in a running bond pattern with each additional course adhered to the lower course with Plexus MA530 Adhesive in accordance with manufacturer's installation instructions. Max. wall height is 10 ft.

CERTIFIED MODEL: RENco Modular Composite Block

2. INTERIOR AND EXTERIOR CLADDING:
Install two layers of nominal 5/8 in. thick Type X gypsum board with long dimension perpendicular to horizontal joints of block.

Attached to FRP block using #6 W, 1-1/4 in. long bugle-head screws 12 in. on center (oc) around perimeter and 12 in. oc in the field. Second layer of 5/8 in thick Type X gypsum board with joints offset from first layer installed with #6 x 3 in. long bugle-head screws offset by 1 in. of the first layer fasteners.

A. **JOINT TAPE AND COMPOUND – (Not Shown)** Vinyl or casein, dry or premixed, joint compound applied to face layers of gypsum board (Item 1) in two coats to all exposed fastener heads and board joints. A min. 2 in. wide paper, plastic, or fiberglass tape is embedded in first layer of compound over joints in gypsum board.