

IB EWP Inc.
Design No. IB/MWP 60-03
Floor/Ceiling Assembly
IB EWP Inc. (IB) Series I Joists
ASTM E119 and CAN/ULC S101
Fire Resistance Rating: 1 Hour

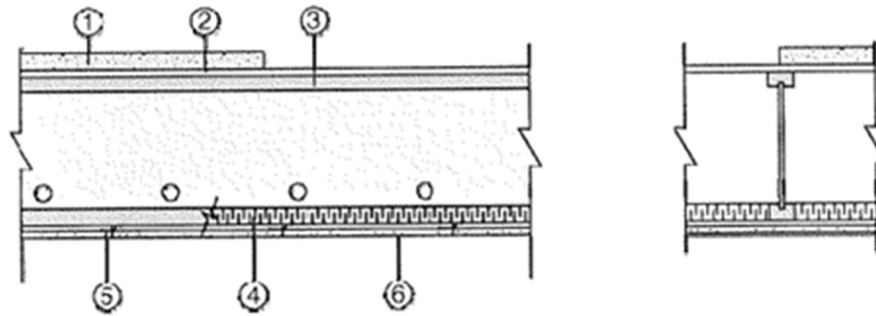

1. **FLOOR TOPPING (Optional):** Lightweight concrete or proprietary topping.
2. **SUB-FLOORING:** Min. 5/8 in. thick plywood or Oriented Strand Board (OSB) installed perpendicular to joists, with end joints staggered. Min. sheathing thickness (based on framing spacing) and fastener schedules shall comply with the Code.
3. **CERTIFIED MANUFACTURER:** IB EWP Inc.
CERTIFIED PRODUCT: IB I Joist
CERTIFIED MODEL: IB600, IB800 or IB900x
I-joists having a min. depth of 9-1/2 in., installed at 24 in. on center (oc) max.
4. **INSULATION:** Min. 2 in. thick mineral wool insulation batts – 3.5 pcf (min.), friction fitted between the bottom flanges of the joists and supported by wood setting strip edges. Ends of batts shall be centered over resilient channels and tightly butted.
5. **RESILIENT CHANNEL:** Min. 0.019 in. thick (28 GA) galvanized steel resilient channel attached perpendicular to the bottom flange of

the joists with one 1-1/8 in. drywall screw. Channels spaced a max. of 16 in. oc. Additional channels are required at gypsum board end joints such that each board is attached to a separate channel. These additional channels shall extend to the next joist on each side of the board end joint.

6. **GYPSUM BOARD:** Min. 5/8 in. thick Type C gypsum wallboard installed with long dimension perpendicular to resilient channels and fastened to each channel with min. 1-1/8 in. long Type S drywall screws. Fasteners spaced 7 in. oc and 1-1/2 in. from panel edges and ends. Edge joints shall be centered between joists. End joints shall be staggered one channel spacing.
7. **WOOD SETTING STRIPS (Not Shown):** Min. 1x4 (nominal) wood setting strips attached with 1-1/2 in. long Type W screws at 24 in. oc along the bottom flange of joist creating a ledge to support insulation.
8. **FINISHED SYSTEM (Not Shown):** Face layer joints covered with tape and coated with joint compound. Screw heads covered with joint compound.