

Kingspan Insulated Panels, Inc.
Design No. KIP/IMWP 30-08
Insulated Metal Wall Panels
DESIGNWALL 2000R
NFPA 285
Rating: Meets Conditions of Acceptance

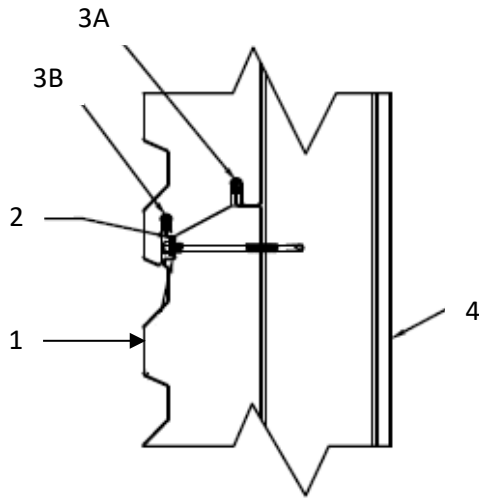

Standard Panel Joint

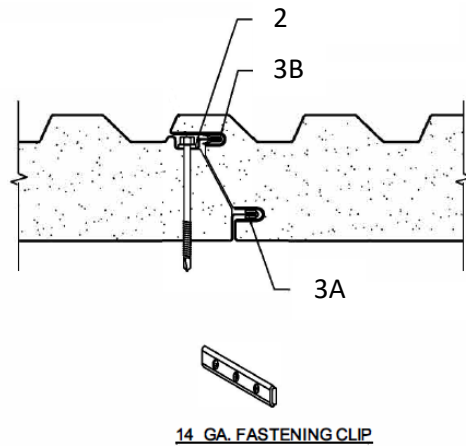

Standard Panel Joint (Vertical)

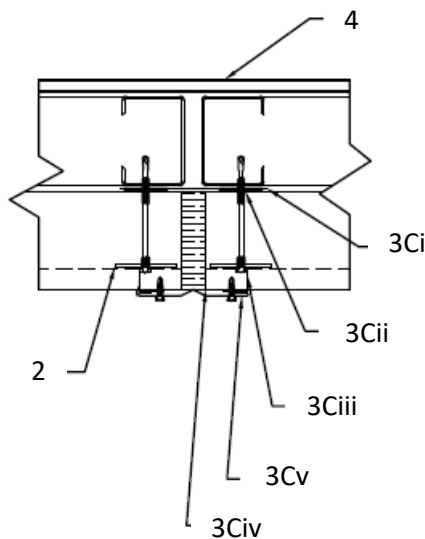

Butt Joint (Horizontal)

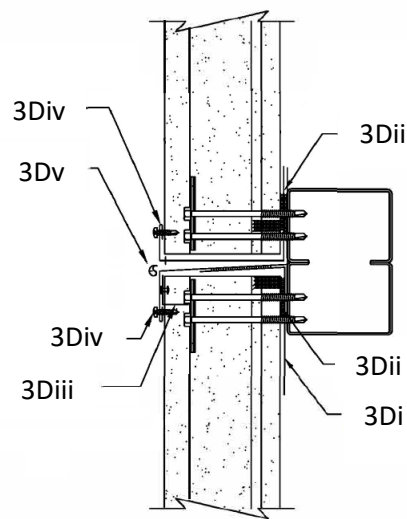

Stack Joint (Vertical)



1. COMPONENT NAME: Insulated Metal Wall Panel

CERTIFIED PRODUCT: Kingspan Insulated Panels, Inc. – Designwall 2000R

Attach 12 in., 16 in., 20 in., or 24 in. wide × max. 4 in. thick Designwall 2000R panels, oriented horizontally or vertically, to the exterior side of steel framing. Designwall 2000R panels use Kingspan’s proprietary QuadCore-B rigid foam core with 24 GA interior and 22 GA exterior galvanized or galvalume facings.

2. FASTENERS AND CLIPS: Fix panels to steel framing using 1/4 in. diameter HWH self-drilling sheet metal fasteners and manufacturer-supplied 14 GA stainless steel, 3 hole-clips with PVC backer. Use appropriate length fasteners based on the thickness of the panel. Space clips 6 ft. on center (oc) when installing panels oriented vertically, or 4 ft. 3 in. oc when installing panels oriented horizontally. Use a min. of two fasteners per clip.

3. JOINTS AND SEAMS: Construct joints and seams as follows:

- A. FINNED GASKET – Install manufacturer-supplied finned gaskets in the interior panel-to-panel joints.
- B. WEDGE GASKET – Install manufacturer-supplied wedge gaskets in the exterior panel-to-panel joints.
- C. BUTT JOINT – When panels are installed horizontally and vertical joints are required, install the following:
 - i. MENDING PLATE: Install 6 in. × 22 GA steel mending plates over the studs.
 - ii. BUTYL SEALANT: Apply a bead of butyl sealant over each steel mending plate. Set the panels into the butyl sealant before fixing the panels to the steel framing.

- iii. RIBBED METAL CLOSURE: Fix ribbed metal closure to the panels using pop rivets spaced max. 8 in. oc.
- iv. MINERAL FIBER STRIP: Install 4 in. × 1-1/4 in., min. 4 pcf noncombustible mineral fiber strips complying with ASTM E136 in the vertical butt joint.
- v. VERTICAL CAP TRIM: Attach 4-1/2 in. wide vertical cap trim over the joint using #10 × 3 in. long metal-to-metal stitching screws or pop rivets spaced 8 in. oc.

D. STACK JOINT – When panels are installed vertically and horizontal joints are required, install the following:

- i. MENDING PLATE ANGLE: Install 3 in. × 4 in. × 22 GA mending plates over the studs.
- ii. BUTYL SEALANT: Apply a bead of butyl sealant over each mending plate. Set the panels into the butyl sealant before fixing the panels to the steel framing.
- iii. RIBBED METAL CLOSURE: Fix ribbed metal closure to the panels using pop rivets spaced max. 8 in. oc.
- iv. STACK TRIM: Fix J-trim using #10 × 3/4 in. HWH self-drilling sheet metal fasteners spaced 12 in. oc to the bottom of the upper panel, and fix Z-trim using #10 × 3/4 in. HWH self-drilling sheet metal fasteners spaced 12 in. oc to the top of the lower panel.
- v. WEEP HOLES: Field drill 3/8 in. weep holes at 24 in. oc.

4. INTERIOR CLADDING: When panels are oriented horizontally, install 5/8 in. Type X gypsum board on the interior side of the steel framing. Fix the gypsum board to the steel framing using #6 × 1 in. long self-drilling screws spaced 8 in. oc along the edges and ends, and 12 in. oc along intermediate studs. When panels are oriented vertically, 5/8 in. Type X gypsum board interior cladding is optional.



5. WINDOW FLASHING: Install 6 in. × 3 in. × 24 GA galvanized steel trim to the exterior and interior surfaces of the assembly using #10 × 3/4 in. long metal-to-metal stitching screws spaced 12 in. oc. When the panels are oriented horizontally, install 4 in. × 1-1/4 in., min. 4 pcf noncombustible mineral fiber strips complying

with ASTM E136 along the left and right window jambs, behind the window flashing.

6. FLOORLINE FIREBLOCKING: Install min. 4 pcf mineral wool at each floorline using Z-clips or equivalent.

Consult the listing report on the Directory of Building Products (<https://bpdirectory.intertek.com>) for the edition of the standard(s) evaluated.

Compliance of the assembly described in this Design Listing with the referenced standard relies on verification that the assembly constructed in the field is consistent with that described herein. Intertek certified products may be verified by the approved Intertek label; other products must be verified by the Authority Having Jurisdiction as meeting the specifications stated herein.