

CENTRIA
Design No. CSG/CWP 30-03
(Vertical or Horizontal Installation)
Non-Load Bearing Insulated Metal Wall Panel
Formawall Dimension Series
NFPA 285
Rating: Meets Conditions of Acceptance

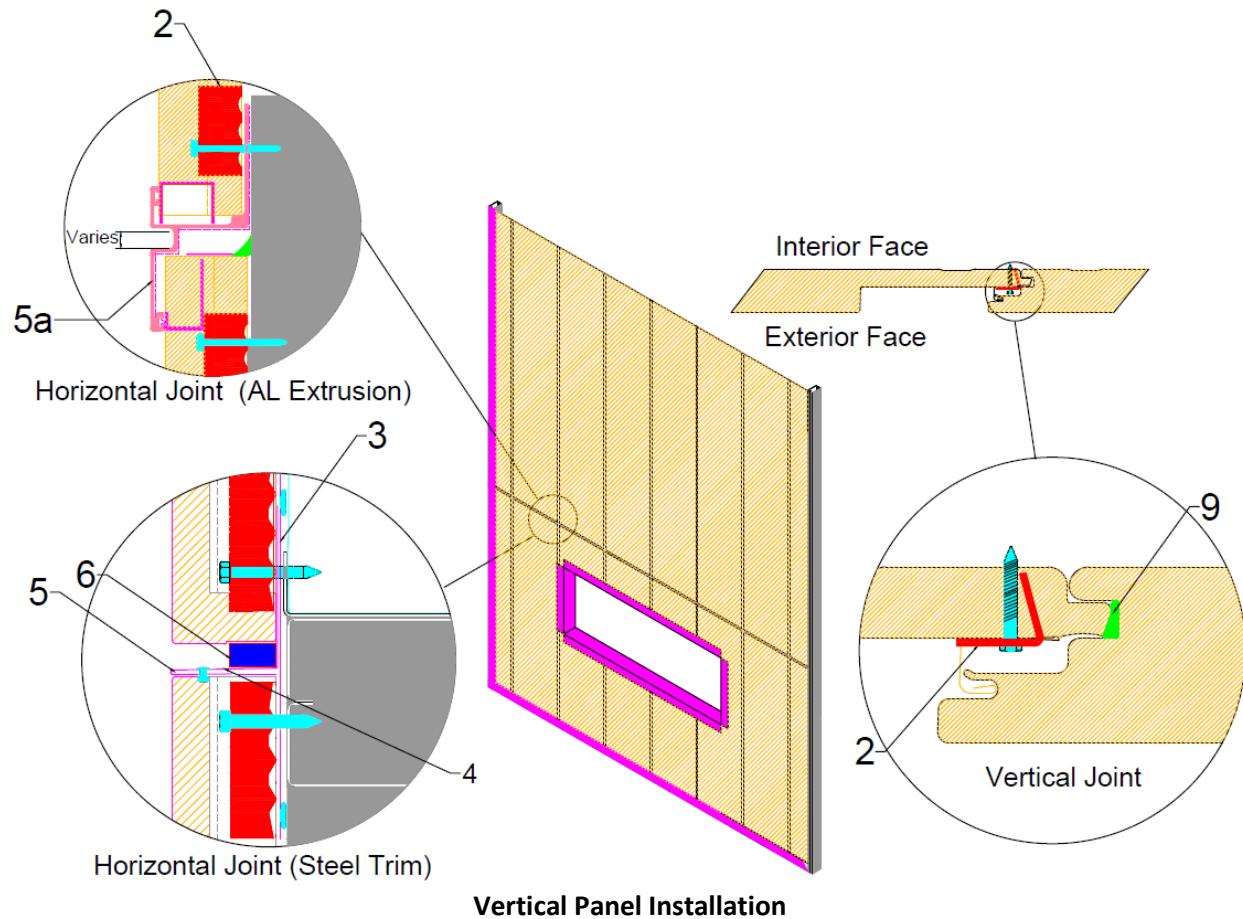

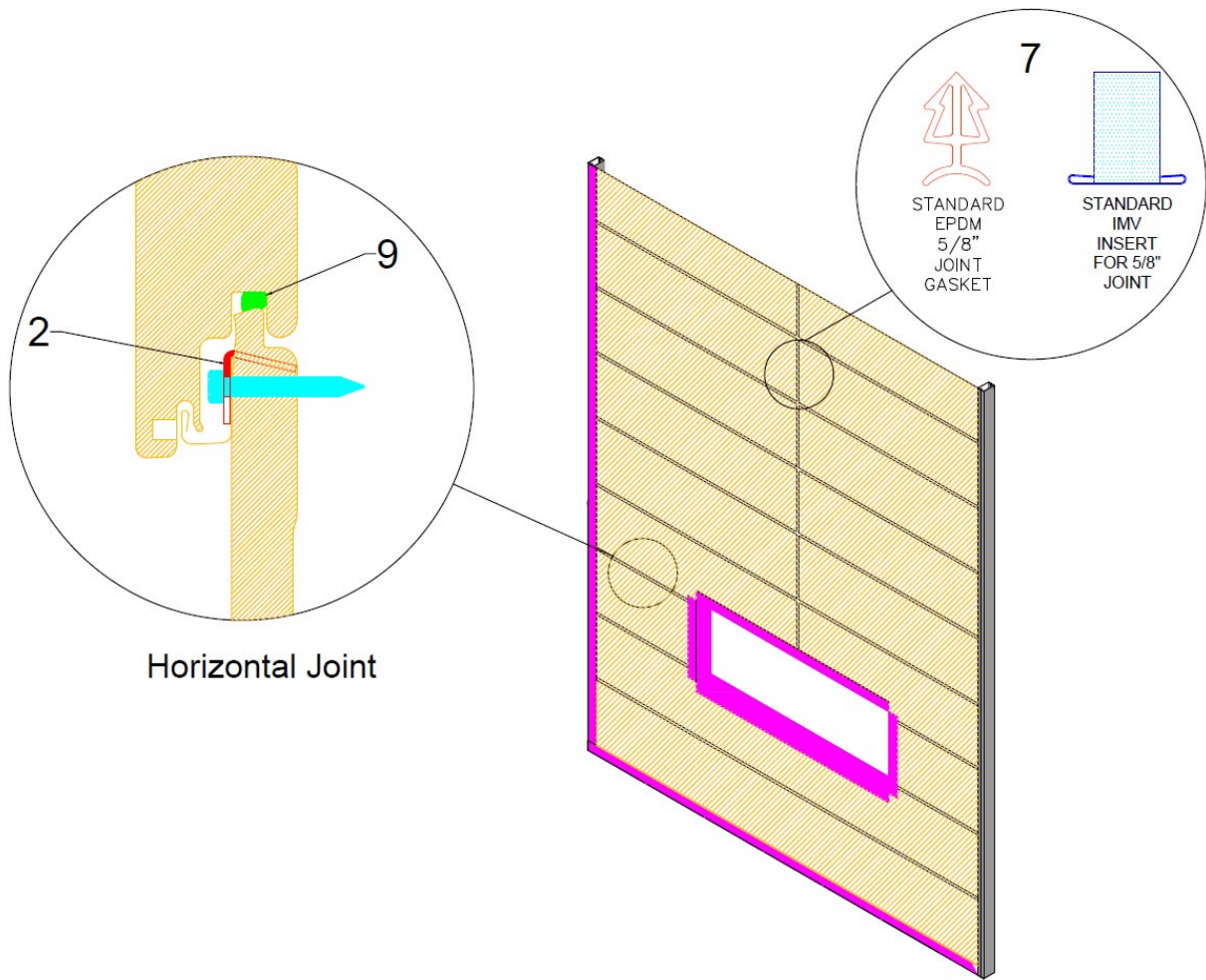

Horizontal Panel Installation

1. CERTIFIED MANUFACTURER: CENTRIA

CERTIFIED PRODUCT: Exterior Polyisocyanurate Insulated Metal Panel

CERTIFIED MODEL: Formawall

- Dimension Series
- Dimension Series Graphix
- Dimension Series DS58

PANEL SPECIFICATIONS:

- Panel Thickness – Min. 2 in., max.3 in.

- Min. distance between panels for vertical joint with panels installed in horizontal direction is 5/8 in., max. of 3 in.
- Panel Width – 24 in. min. when installed horizontally, 12 in. min. when installed vertically.
- Reveal – (Vertical Panels) Min. 1/8 in., 1/2 in. to 6 in. max., in 1/2 in. increments. (Horizontal Panels) Min. 1/2 in. to 6 in. max., in 1/2 in. increments.
- Exterior Face: G90 galvanized steel or 304/304L alloy stainless steel, min. 22 GA, max. 20 GA



- Interior Liner: G90 galvanized steel, min. 26 GA, max. 20 GA

Install the wall panels vertically or horizontally by interlocking the double tongue and groove edges of the panels. Panels are attached to structure utilizing panel clips fastened with 1/4 in. self-tapping screws.

- 2. PANEL ATTACHMENT CLIP:** Located inside each long edge joint. Clips attach horizontal panels to structural wall support at max. spacing of 16 in. on center (oc) and vertical panels spaced a max. of 44 in. oc.
- 3. STACK JOINT BACK UP FLASHING:** (Vertical Panel Installations) Min. 22 GA flashing installed at each horizontal stack joint bridging the gap in the joint at the liner side of the panel. The flashing is fastened to the backside of the panel above and below the supports with 1/4 in. x 1 in. self-drilling screws spaced 9 in. oc.
- 4. STACK JOINT/VERTICAL JOINT COVER PLATE:** (Vertical Panel Installations) 22 GA flat installed on the lower panel in the stack joint at the reveal.
- 5. STACK JOINT TRIM:** (Vertical Panel Installations) Min. 22 GA flashing installed continuous at each horizontal stack joint and pop riveted to panel on each side of joint and midpoint of panel. The

flashing is also fastened to wall structural support with the panel clip fastener.

- 5a. STACK JOINT ALUMINUM EXTRUSION:** (Vertical Panel Installations) As an option may be installed in lieu of 22 GA steel flashing items.
- 6. STACK JOINT GASKET:** (Vertical Panel Installations) Continuous 3/4 in. x 7/8 in. EPDM foam gasket installed horizontally.
- 7. IMV AND VERTICAL JOINT GASKET:** (Horizontal Panel Installations Along Ends of Panels) Approved EPDM gaskets are manufactured by American National Rubber and Clark Rubber Plastics. Approved Neoprene gaskets are manufactured by Tremco. Insulated Metal Vertical (IMV) joint insert is fabricated by CENTRIA.
- 8. WINDOW FLASHING:** Min. 22 GA L-shaped steel flashing installed to enclose the perimeter of the opening. Aluminum extrusions may be used in lieu of the flashing.
- 9. SEALANT:** Factory applied non-curing butyl.
- 10. STUD FRAMED CORE WALL:** (Not Shown) 6 in. wide, 16 GA galvanized steel studs.
- 11. STEEL TUBE FRAMED CORE WALL:** (Not Shown) Optional 4 in. x 6 in. deep 1/4 in. steel tubes.