

## Trussbilt Manufacturing Membrane Penetration Firestop System

### Detail No. P2-7

Investigated by Intertek for compliance with ASTM E814. For use with Trussbilt's Fire Rated Wall Panel System TBM/MWP 60-01 or TBM/MWP 120-01. For use with non-load bearing wall installations.

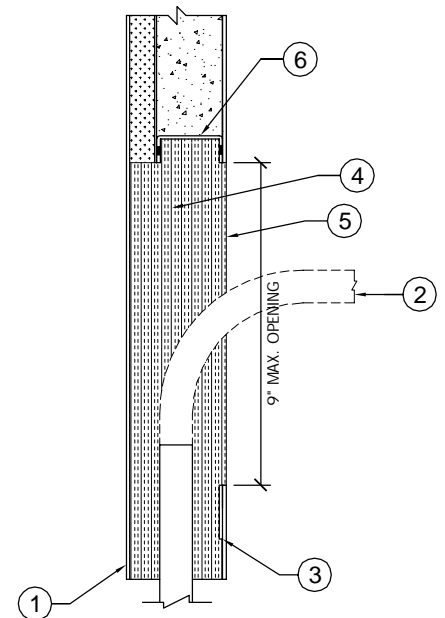
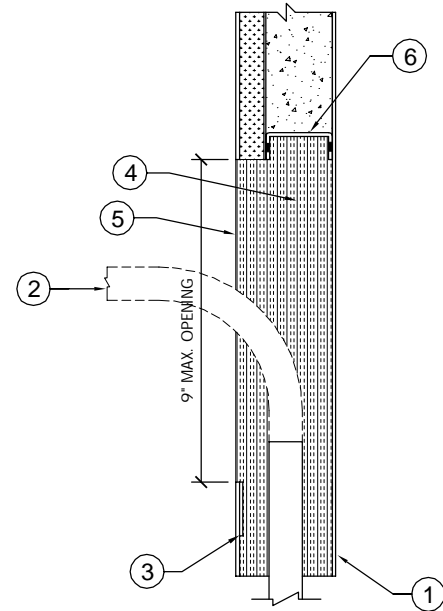
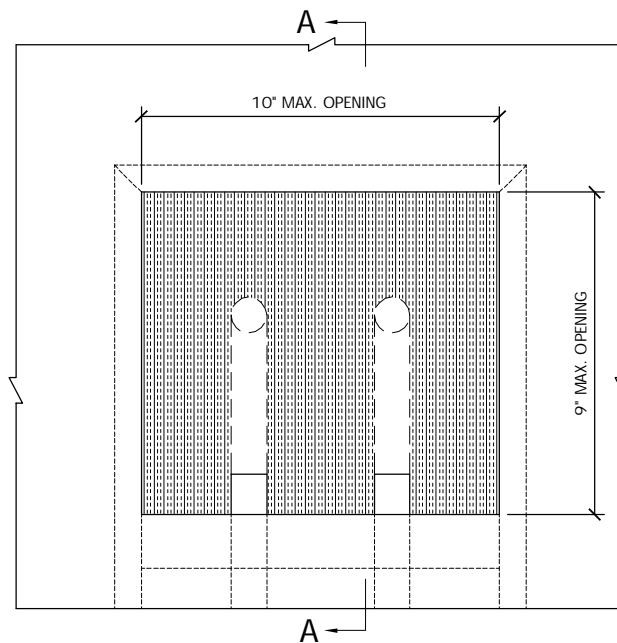

1. Trussbilt fire rated wall panel TBM/MWP 60-01 (1 hour rating) or TBM/MWP 120-1 (2 hour rating)
2. Intertek/UL listed conduit.
3. 12 gauge steel reinforcement.
4. Mineral wool, min. 4 pcf density, compressed 50%, flush with panel surface.
5. Hilti CFS-SP WB joint spray to overlap opening edges a minimum of  $\frac{1}{2}$ " on box opening side.
6. Minimum 12 gauge steel channel at top & sides.

A-A