

Trussbilt LLC
Design No. TBL/MWP 60-01
Fire Rated Trusswall Panel
ASTM E119, CAN/ULC S101, UL 263
Rating: 1 Hour, Bearing Wall Assembly
Max. Load: 1,700 PLF

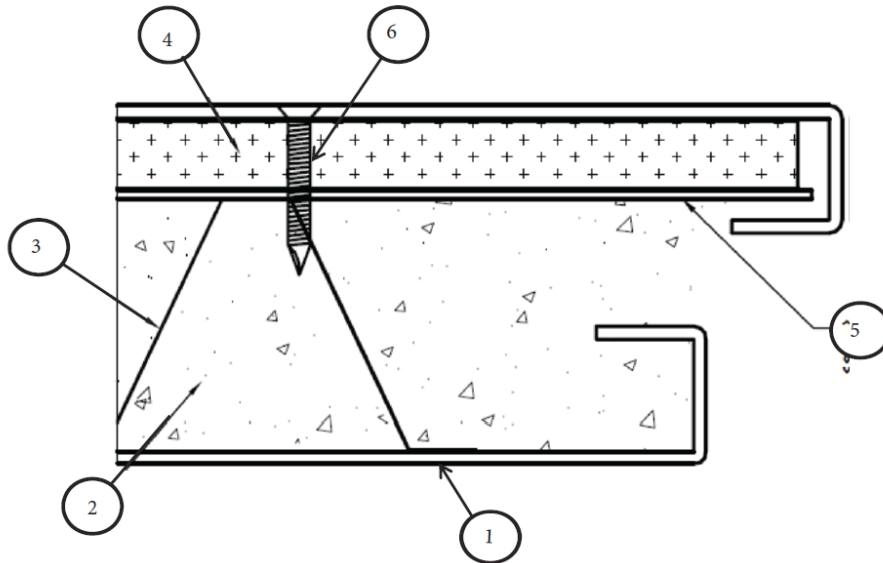

CERTIFIED MANUFACTURER: Trussbilt LLC

CERTIFIED PRODUCT: Fire Rated Wall Panel

CERTIFIED MODEL: Trusswall

COMPONENTS:

1. 12 GA steel outer skins; ASTM A1011A/A1011M Mild Steel, ASTM A653A/A653M Galvanized Steel, or ASTM A240/A240M 409 Series Stainless Steel
2. Max. 3/8 in. aggregate size early strength cement (filled in field)

3. 28 GA steel stiffeners

4. Min. 1/2 in. thick G-P DensGlass sheathing attached to the inner skin and inside of outer skin with Marathon 292 SEE-GEE non-combustible adhesive or with fasteners (see Item 6.)

5. 16 GA steel inner skin

6. 1-1/4 in. long, 8-32 F.H carbon steel screws welded and finished smooth with vertical spacing 24 in., min. 8 in. from ends, and horizontal spacing 16 in., min. 4 in. from edge