

---

**Stiles Custom Metal, Inc.**  
**Design No. SCM/SW 120-01**  
**Steel Window**  
**StileLite 200 Glazing Framing System**  
**ASTM E119 (2010), UL 263 (2011), CAN/ULC S101 (2007)**  
**Rating: 2 Hour**

---

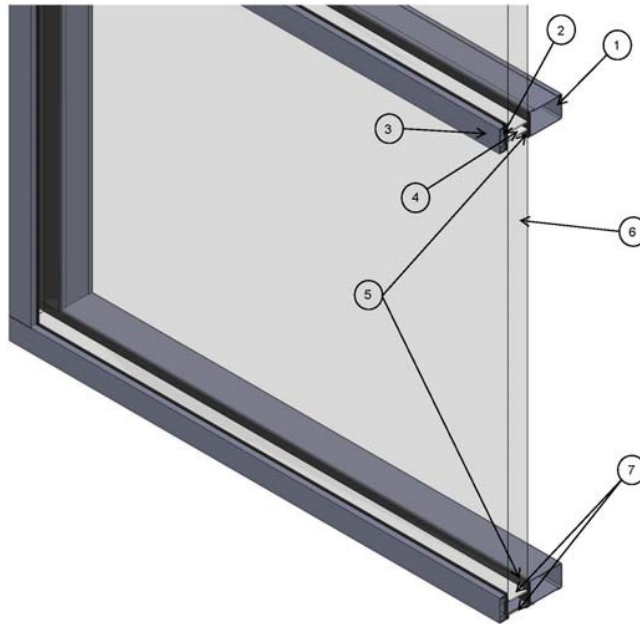

**1. CERTIFIED MANUFACTURER:** Stiles Custom Metal

**CERTIFIED PRODUCT:** Glazing Framing System

**MODEL:** StileLite 200

1. **STEEL FRAMING MEMBERS** – Min. 14 GA steel with a nominal 2-3/8 in. width and a nominal depth of 3-1/2 in., with lengths cut according to glazing opening size. Secured to wall with 1/4 in. diameter x 3 in. long hex-head screws fastened 6 in. from the end and every 17 in. on center (oc). Framing member can incorporate vertical or horizontal mullions.
2. **PRESSURE CAP** – Min. 12 GA steel glass retainer with a nominal 2-3/8 in. width

and a nominal depth of 0.611 in., with lengths cut according to glazing size. A min 18 GA steel cap retainer is inserted into the steel pressure cap prior to fastening to the framing members. The pressure cap and cap retainer assembly is then secured to the framing members with min. 1/4 in. x 3-1/2 in. cap-head screws and neoprene washers located every 12-1/16 in. oc.

3. **FACING PROFILES** – Min. 18 GA steel with a nominal 2-3/8 in. width and a min. depth of 0.611 in., with lengths cut according to glazing size. Facing profiles snap over the pressure caps with no mechanical fasteners.



4. PRESSURE PLATE SCREWS – 1/4 in. × 4 in. long self-drilling screws. Studs are to be located 100mm from each end of the steel framing member and then every 300mm oc.
5. GASKETS – Nominal 2-5/16 in. wide × nominal 1/4 in. thick neoprene strip applied to the steel framing members and the pressure caps to cushion the glazing materials when installed.
6. FIRE RESISTANCE GLAZING MATERIAL – For 1 hour assemblies, nominal 1 in. min. thickness laminated glass in various sizes. For 1-1/2 hour and 2 hour assemblies, nominal 2-1/8 in. min. thickness laminated glass panels in various sizes. Max. exposed size of glazing for 1 hour assemblies not to exceed 26.7 ft<sup>2</sup> with a max. horizontal or vertical dimension of 87-5/8 in. Max. size of glazing for 1-1/2 hour and 2 hour assemblies not to exceed 29.3 ft<sup>2</sup> with a max. exposed horizontal or vertical dimension of 100-7/8 in.
  - a. Min. 2-1/8 in. thick AGC Flat Glass Europe/AGC Interedge Technologies LLC – Pyrobel 120, Pyrobel 120 EG, Pyrobel 120 IGU.
  - b. Glazing listed per UL 263, ASTM E119, CAN/ULC S101.\*
7. INTUMESCENT – 1/8 in. thick × 2 in. wide fire rated intumescent strips to be applied to the edges of the glazing as well as the end channels.
8. WALL ASSEMBLY (Not Shown) – A min. 2 hour fire rated wall assembly.
9. FILL, VOID, OR CAVITY MATERIALS – Tightly packed mineral wool to be installed between the framing members and the wall assembly. Fire rated caulking material may be applied over the insulation.

\*NOTE: Max. exposed size of glazing is restricted by the size tested above or the max. allowed per the glazing specifications, whichever is smaller.