

Parklex Prodema USA, Inc.
Design No. PUI/CWP 30-02
Exterior – Non-Load Bearing Wall Assembly
NATURCLAD-W F Composite Wall (HPL) Panel
NFPA 285
Rating: Meets Conditions of Acceptance

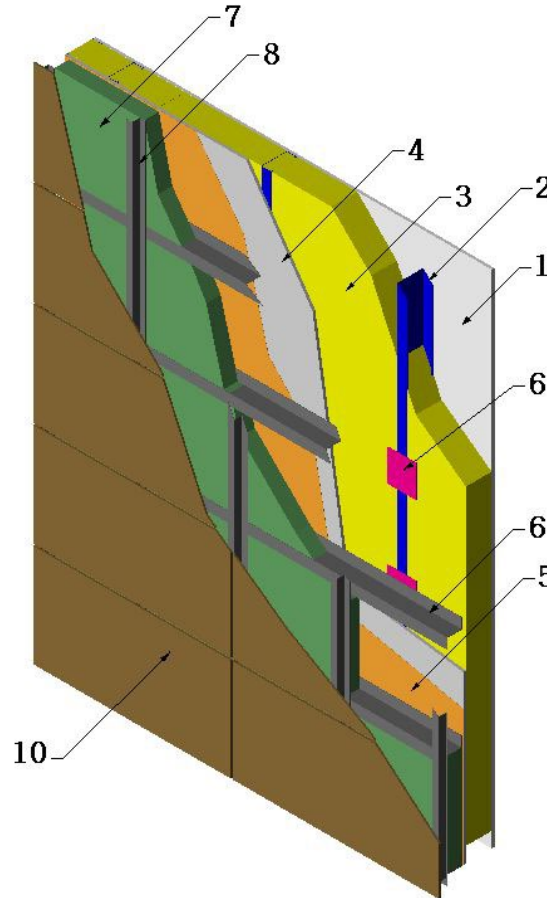

Concept drawing not to scale

1. **INTERIOR CLADDING:** On the interior side of the exterior wall assembly, apply one layer of 5/8 in. thick, Type X gypsum board (ASTM C1396) with the long dimension perpendicular to the steel framing. Secure using #6 x 1-1/4 in. long, corrosion-resistant, Type S, steel self-piercing tapping screws (ASTM C1002), spaced 8 in. on center (oc) around the perimeter and 12 in. oc in the field.
 - A. **JOINT TAPE AND COMPOUND** – (Not Shown) Vinyl or casein, dry or premixed joint compound (ASTM C475) applied to face layers of gypsum board in two coats (ASTM C840) to all exposed fastener heads and board joints. A min. 2 in. wide paper, plastic, or fiberglass tape (ASTM C475) is embedded in first layer of compound over joints in gypsum board.



2. **STEEL STUDS:** Min. 3-5/8 in., 18 GA, galvanized steel studs. Max. spacing, 16 in. oc. Secure steel studs to 18 GA top and bottom tracks using 1/2 in. long, S-12, steel drill screws (ASTM C954).

3. **STUD CAVITY INSULATION:** Install nominal 16 in. wide x 3-1/2 in. thick CertainTeed R-13 unfaced fiberglass insulation (ASTM C665, Type I) in cavities between steel studs.

A. **FLOOR LINE CAVITY INSULATION** – (Not Shown) Install 4 in. thick, 8 in. high, 4 pcf mineral wool (ASTM C665, Type I), and friction fit in the stud cavities at the floor lines.

4. **EXTERIOR SHEATHING:** Install one layer of 1/2 in. thick Georgia Pacific DensGlass® Sheathing (ASTM C1177) to the exterior side of the exterior wall assembly. Install sheathing with the long dimension perpendicular to the steel framing and secure using #6 x 1-1/4 in. long, corrosion-resistant, Type S, steel self-piercing tapping screws (ASTM C1002), spaced 8 in. oc around the perimeter and 12 in. oc in the field.

A. **JOINT TAPE AND COMPOUND** – (Not Shown) Vinyl or casein, dry or premixed joint compound (ASTM C475) applied to face layers of gypsum sheathing in two coats (ASTM C840) to all exposed fastener heads and board joints. A min. 2 in. wide paper, plastic, or fiberglass tape (ASTM C475) is embedded in first layer of compound over joints in gypsum sheathing.

NOTE: Items #1 through #4 may be replaced by "Code-complying" brick, or masonry construction.

5. **VAPOR BARRIER:** Install VaproShield® RevealShield™ SA self-adhering membrane

vertically over exterior sheathing side lapping a min. 4 in. at vertical seams.

6. **BRACKETS AND "L" EXTRUSIONS:** Install 5/32 in. thick x 3-9/16 in. wide x 5-1/4 in. high aluminum brackets (not shown) through 5/32 in. thick x 3-9/16 in. wide x 5-1/4 in. high insulator pads (not shown) to the steel studs, spaced 24 in. oc vertically and fastened using two #14 x 1-1/2 in. long hex-head screws (not shown). Attach 1/8 in. thick x 1-9/16 in. x 2-7/8 in. leg aluminum "L" profiles to the aluminum brackets, to provide horizontal support for the exterior insulation and vertical J-channels and hat channels, using two #14 x 1-1/2 in. long hex-head screws.

NOTE: Where application of the brackets is to a substrate of "Code-complying" brick or masonry construction, fastening of the brackets to the substrate utilizes 1/4 in. shank x min. 1-1/4 in. long "Tapcon-type" concrete anchor screws 24 in. oc vertically and horizontally into the brick or masonry construction.

7. **EXTERIOR INSULATION:** Install nominal 2-1/2 in. thick x 24 in. wide x 48 in. long 4 pcf Roxul CavityRock® DD mineral fiber insulation (ASTM C665, Type I) friction fit horizontally in between the "L" profiles.

8. **J-CHANNEL AND HAT CHANNEL:** (Vertically) Install nominal 12 GA x 3 in. wide x 1 in. deep x 1-1/8 in. leg. J-channel, or nominal 11 GA x 4-1/4 in. wide x 1 in. deep x 1-1/2 in. leg hat channel to "L" extrusions (Item #6). Install using # 7 x 3/4 in. long hex-head screws spaced 24 in. oc vertically through the channels into the "L" profiles. Overlap channel lengths a min. of 1 in. Install vertical J-channels and hat channels spaced in accordance with the approved construction drawings.



9. WINDOW PENETRATION: (Not Shown) Install 18 GA steel sheet around the perimeter of the window opening spanning from interior to exterior of the assembly attached nominally 24 in. oc using # 7 x 3/4 in. long hex-head screws to the "L" profiles.

10. EXTERIOR CLADDING: NATURCLAD-W F Composite Wall Panels. Install nominal 4 ft. x 8 ft. x 8mm thick NATURCLAD-W F composite wall panels using min. 1-1/4 in. long Torx (Part #1395850) or Irius (Part #1241462) fasteners through pre-drilled holes in the panel.

Pre-drilled holes are slightly oversized, spaced 1-1/4 in. to 1-1/2 in. from panel edges, and spaced for fastening nominally 21 in. oc vertically to the perimeter and intermittent vertical J-channels and hat channels in accordance with the construction drawings. Vertical joints are not permitted above openings and no horizontal joints within 3 ft. over the openings.

Consult the listing report on the Directory of Building Products (<https://bpdirectory.intertek.com>) for the edition of the standard(s) evaluated.

Compliance of the assembly described in this Design Listing with the referenced standard relies on verification that the assembly constructed in the field is consistent with that described herein. Intertek certified products may be verified by the approved Intertek label; other products must be verified by the Authority Having Jurisdiction as meeting the specifications stated herein.