

BASF/FI 30-05
Non-Load Bearing Wall System
BASF Corporation
WALLTITE® US and WALLTITE® HP+
NFPA 285 (2012)
Rating: Meets the Requirements

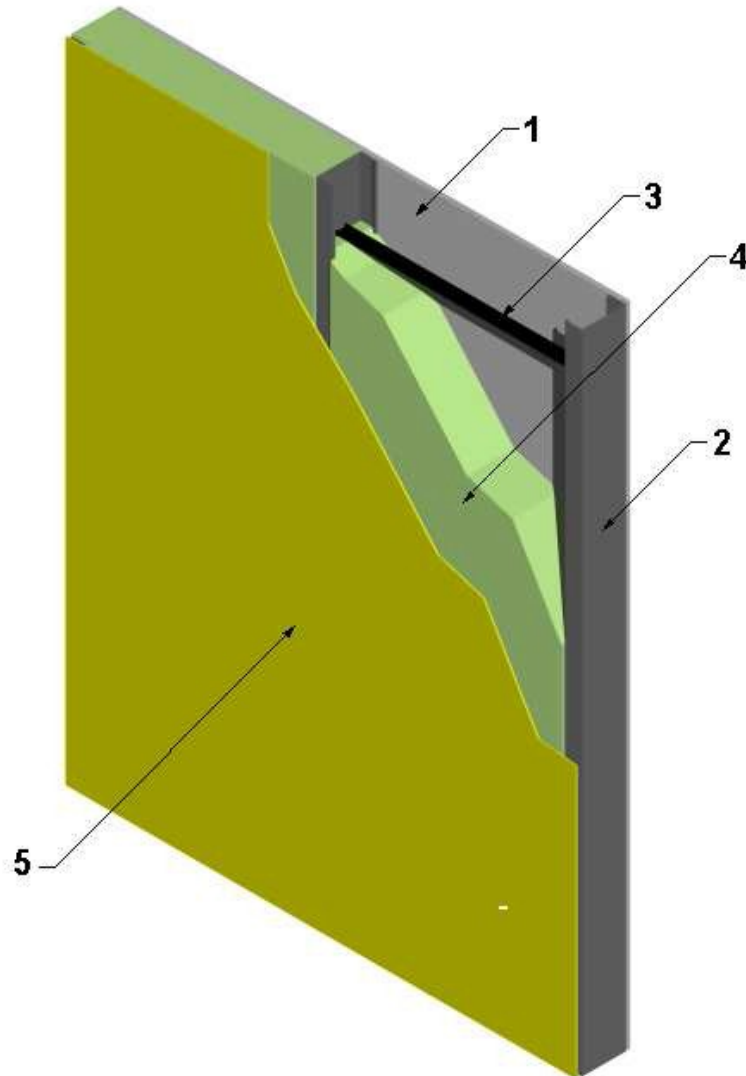

1. INTERIOR CLADDING: Install nominal 5/8 in. thick Type X gypsum board with long dimension perpendicular to steel studs (Item 2). Attach to steel studs (Item 2) using # 6 Type S, 1-1/4 in. long bugle-head screws spaced 8 in. on center (oc) around perimeter and 12 in. oc in the field.

A. JOINT TAPE AND COMPOUND – (Not Shown) Vinyl or casein, dry or premixed joint compound applied to face layers of gypsum board (Item 1) in two coats to all exposed fastener heads and board joints. A min. 2 in. wide paper, plastic, or fiberglass tape is embedded in first layer of compound over joints in gypsum board (Item 1).

2. **STEEL STUDS:** Use 3-5/8 in. deep, 20 GA, galvanized steel studs spaced nominal 24 in. oc. Secure steel studs to 20 GA top and bottom tracks using 7/16 in. long self-pan head framing screws.
3. **LATERAL BRACING:** Install 16 GA lateral bracing perpendicular to steel studs (Item 2) spaced 48 in. oc vertically.
4. **CERTIFIED MANUFACTURER:** BASF Corporation.

CERTIFIED PRODUCT: Polyurethane Foam Insulation

MODEL: WALLTITE® US and WALLTITE® HP+

Spray-apply 3-1/2 in. of nominal 2.1 pcf density insulation in the stud cavies.

5. **EXTERIOR SHEATHING:** Install 5/8 in. thick DensGlass® Gold Exterior Sheathing water repellent gypsum perpendicular to steel studs (Item 2). Attach using # 6 Type S, 1-1/4 in. long bugle-head screws spaced 8 in. oc around the perimeter and 12 in. oc in the field.