

Design Number SWD/FIP 30-01
Non-Load Bearing Wall System
SWD Urethane
SWD Quik-Shield® 112
NFPA 285

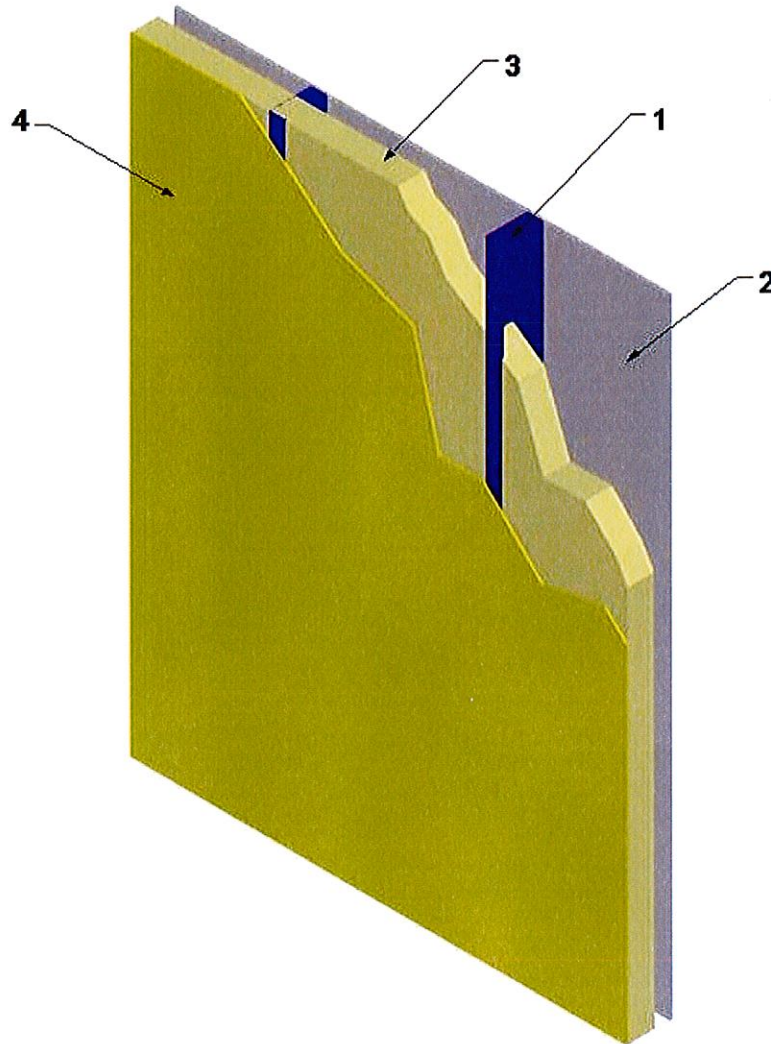

1. STEEL STUDS: Install 6 in. deep, 18 GA galvanized steel studs spaced maximum 24 in. on center (oc). Secure steel studs to 6 in. deep 18 GA top and bottom track (not shown) using #8, 7/16 in. long, self-tapping, pan head framing screws.

2. GYPSUM BOARD: Install 5/8 in. thick Type X gypsum board with long dimension perpendicular to steel studs (Item 1). Attach to steel studs (Item 1) using #6 Type S, 1-1/4 in. long, self-tapping, bugle head screws spaced 8 in. oc around perimeter and 12 in. oc in the field.

Division 07 – Thermal and Moisture Protection
07 21 00 Thermal Insulation
07 21 19 Foamed-In-Place Insulation

Page 2 of 2

- A. JOINT TAPE AND COMPOUND – (Not Shown) Apply a level 2 finish of vinyl or casein, dry or premixed joint compound applied to the following elements: Apply to gypsum board (Item 2) in two coats to all exposed fastener heads and gypsum board joints. Embed minimum 2 in. wide paper, plastic, or fiberglass tape in first layer of compound over joints in gypsum board (Item 2).
3. CERTIFIED COMPANY:
SWD Urethane
- CERTIFIED PRODUCT:
Spray Polyurethane Foam Insulation
- MODEL: SWD Quik-Shield® 112
- INSULATION: Spray-apply a nominal 3-1/2 in. thick layer of nominal 2.0 pound per cubic foot density layer of SWD Quik-Shield® 112 Spray Polyurethane Foam to exterior sheathing (Item 4) side of the steel stud (Item 1) cavity.
4. EXTERIOR SHEATHING: Install 5/8 in. thick, GP DensGlass® Gold Exterior Sheathing to the exterior side of steel studs (Item 1). Install sheathing with long dimension perpendicular to steel studs using #6 Type S, 1-1/4 in. long self-tapping, bugle head screws spaced 8 in. oc around perimeter and 12 in. oc in the field.
5. EXTERIOR CLADDING (Optional-Not Shown): Install ASTM E 136 compliant non-combustible exterior cladding to the exterior side of the exterior sheathing (Item 4), in accordance with the applicable building code requirements.