

**SWD Urethane**  
**Design No. SWD/FIP 30-02**  
**Non-Load Bearing Wall System**  
**SWD Quik-Shield® 118**  
**NFPA 285**  
**Rating: Meets Requirements**

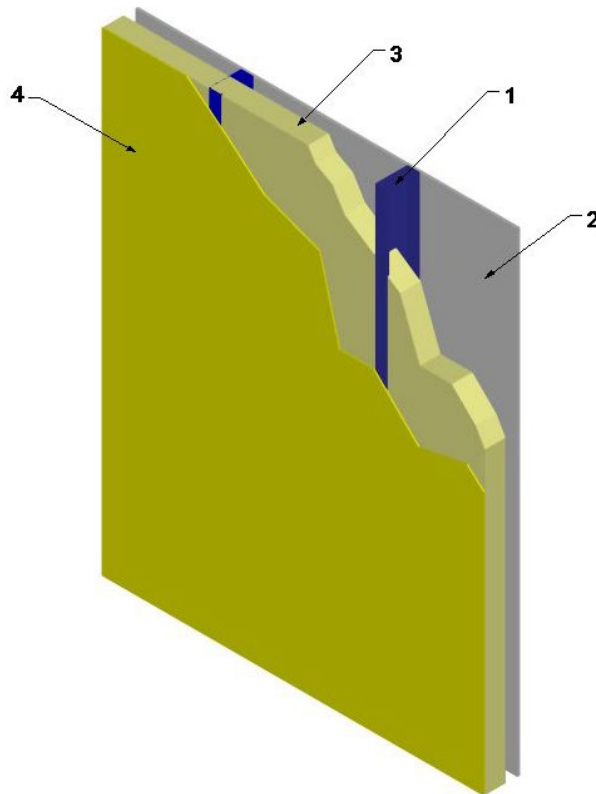

- 1. STEEL STUDS:** Install 6 in. deep, 18 GA galvanized steel studs, spaced max. 24 in. on center (oc). Secure steel studs to 6 in. deep 18 GA top and bottom track (not shown) using #8, 7/16 in. long, self-tapping, pan-head framing screws.
- 2. GYPSUM BOARD:** Install 5/8 in. thick Type X gypsum board with long dimension perpendicular to steel studs (Item 1). Attach to steel studs using #6 Type S, 1-1/4 in. long, self-tapping, bugle-head screws spaced 8 in. oc around perimeter and 12 in. oc in the field.
  - A. JOINT TAPE AND COMPOUND – (Not Shown)** Apply a level 2 finish of vinyl or casein, dry or premixed, joint compound applied to the following elements: Apply to gypsum board in two coats to all exposed fastener heads and gypsum board joints. Embed min. 2 in. wide paper, plastic, or fiberglass tape in first layer of compound over joints in gypsum board.
- 3. WALL CAVITY INSULATION:**

**CERTIFIED PRODUCT:** SWD Quik-Shield® 118 Spray Polyurethane Foam Insulation



**INSULATION:** Spray-apply a nominal 3-1/2 in. thick layer of nominal 2.0 pound per cubic foot density layer of SWD Quik-Shield® 118 Spray Polyurethane Foam to exterior sheathing side of the steel stud cavity.

4. **EXTERIOR SHEATHING:** Install 5/8 in. thick, GP DensGlass® Gold Exterior Sheathing to the exterior side of steel studs. Install sheathing with long dimension perpendicular to steel

studs using #6 Type S, 1-1/4 in. long self-tapping, bugle-head screws spaced 8 in. oc around perimeter and 12 in. oc in the field.

5. **EXTERIOR CLADDING:** (Optional, Not Shown) Install ASTM E136 compliant non-combustible exterior cladding to the exterior side of the exterior sheathing, in accordance with the applicable Building Code requirements.

*Consult the listing report on the Directory of Building Products (<https://bpdirectory.intertek.com>) for the edition of the standard(s) evaluated.*

*Compliance of the assembly described in this Design Listing with the referenced standard relies on verification that the assembly constructed in the field is consistent with that described herein. Intertek certified products may be verified by the approved Intertek label; other products must be verified by the Authority Having Jurisdiction as meeting the specifications stated herein.*