

Pacific Woodtech Corporation
Design No. PWT/WI 90-01
Wood I-Joists
PWT I-Joists
ASTM E119, CAN/ULC S101
Rating: 90 minutes

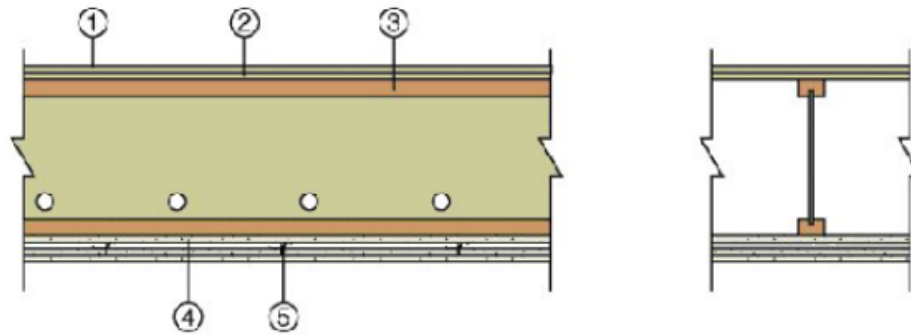

STC Rating With Min. 1-1/2 in. Topping: 54

- 1. TOPPING (Optional):** Lightweight concrete or proprietary topping.
- 2. SUB-FLOORING:** Min. 3/4 in. plywood or OSB, installed with nails and glued with construction adhesive. Alternate: 5/8 in. plywood, OSB, or waferboard with topping.
- 3. WOOD I-JOIST**

CERTIFIED PRODUCT: Pacific Woodtech Corporation, PWT I-Joist

PWT I-Joists having a min. flange dimension of 1-1/2 in. wide by 1-1/2 in. thick and having a min. depth of 9-1/2 in., min. 3/8 in. web, installed at 24 in. on center (oc) max.

- 4. GYPSUM BOARD:** One base layer of 1/2 in. Type X Gypsum wallboard attached to bottom flanges of I-Joists using 1-5/8 Type S drywall screws at 12 in. oc, with the long dimension of wallboard perpendicular to I-Joist. End joints of wallboard

centered on bottom flanges of the I-Joists and staggered from end joints in adjacent sheets.

One middle layer of 5/8 in. Type X gypsum wallboard attached to furring channels using 1 in. Type S drywall screws spaced 12 in. oc, with the long dimension of wallboard perpendicular to furring channels. End joints staggered from end joints in adjacent sheets.

One face layer of 5/8 Type X gypsum wallboard attached to furring channels through middle layer using 3/4 in. Type S drywall screws spaced 8 in. oc. End and edge joints of face layer of wallboard staggered with respect to the middle layer.

- 5. FURRING CHANNELS:** Resilient channels installed perpendicular to joints and spaced 16 in. oc max., fastened with 1-1/2 in. screws at each joist intersection.



Consult the listing report on the Directory of Building Products (<https://bpdirectory.intertek.com>) for the edition of the standard(s) evaluated.

Compliance of the assembly described in this Design Listing with the referenced standard relies on verification that the assembly constructed in the field is consistent with that described herein. Intertek certified products may be verified by the approved Intertek label; other products must be verified by the Authority Having Jurisdiction as meeting the specifications stated herein.