

Pacific Woodtech Corporation
Design No. PWT/WIJ 60-08
Wood I-Joists
PWT I-Joists
ASTM E119, CAN/ULC S101
Rating: 60 minutes

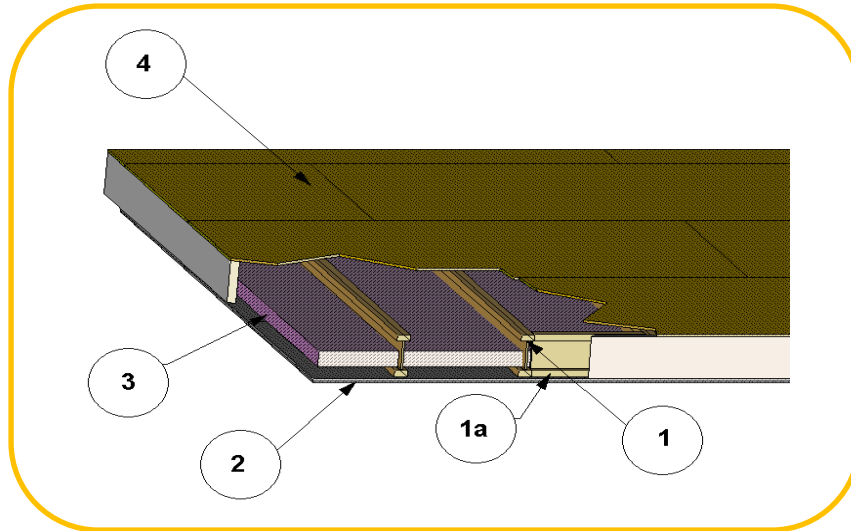

1. WOOD I-JOIST:

CERTIFIED PRODUCT: Pacific Woodtech Corporation, PWT I-Joist

PWT I-Joists having a min. flange dimension of 2-1/2 in. wide by 1-1/2 in. thick and having a min depth of 9-1/2 in., min. 3/8 in. web, installed at 24 in. on center (oc) max.

1a. RIM JOISTS

- 2. GYPSUM BOARD:** Two layers of 1/2 in. Type C wallboard installed perpendicular to joists. Base layer gypsum wallboard installed with end joints located on joists or end joints, staggered min. 16 in. Base layer fastened to joists or channels with 1-5/8 in. coarse-thread gypsum screws, located 12 in. oc. Face layer end and edge joints to be staggered from those of base layer. Face layer

end joints to be located on joists and fastened with #6 2-1/2 in. coarse-thread gypsum screws located 12 in. oc. Face layer board joints to be taped and filled, and screw heads to be filled with joint compound.

- 3. INSULATION (Optional):** Max. 4-1/2 in. thickness fiberglass batt insulation located above joist flanges and supported by stay wires 12 in. apart.
- 4. SUB-FLOORING:** Min. 5/8 in. tongue and groove plywood or OSB, installed perpendicular to joists with end joints staggered, and fastened with Liquid Nail adhesive and 8d common (2.5 in. x 0.131 in.) nails 6 in. oc along the perimeter and at butted joints, and at 12 in. oc in the field.



Consult the listing report on the Directory of Building Products (<https://bpdirectory.intertek.com>) for the edition of the standard(s) evaluated.

Compliance of the assembly described in this Design Listing with the referenced standard relies on verification that the assembly constructed in the field is consistent with that described herein. Intertek certified products may be verified by the approved Intertek label; other products must be verified by the Authority Having Jurisdiction as meeting the specifications stated herein.