

**Metl-Span, A Nucor Company**  
**Design No. MSN/IMWP 15-01**

**Wall Panels**

**Metl-Span CF (Concealed Fastener) and LS-36 Insulated Metal Panels**

**CAN/ULC-S101 (2007)**

**Rating: 15 Min Remain in Place per 2015 National Building Code of Canada Section 3.2.3.8**

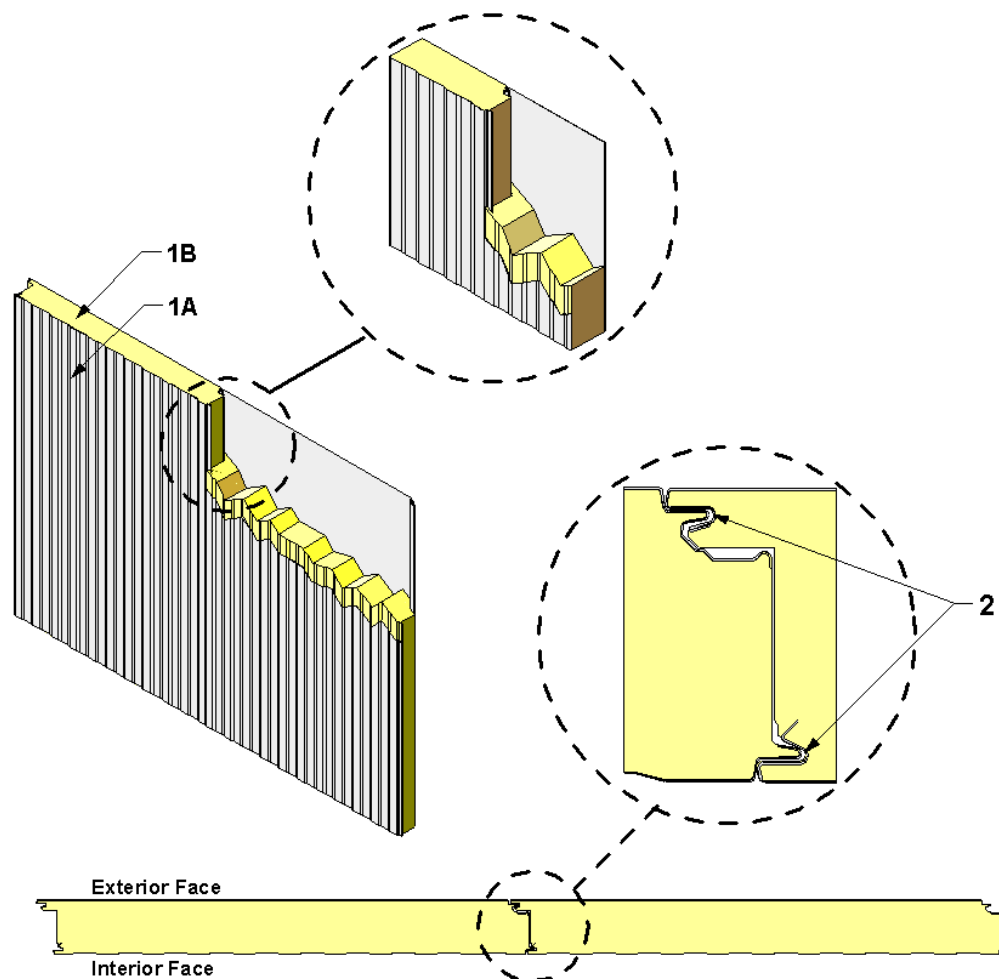

**1. CERTIFIED MANUFACTURER:** Metl-Span, a Nucor Company

**CERTIFIED PRODUCT:** Wall Panels

**CERTIFIED MODEL:** Metl-Span CF and LS-36 Panels

**INSULATED WALL PANELS:** Construct panels nominally measuring 12 in. to 44-1/2 in. wide, having a max. length of 65 ft., and a min. thickness of 6 in. Install panels with the longitudinal (long dimension) edges placed horizontally or vertically. Construct wall panels of the following materials:



- A. PANEL FACING – Construct with two panels (faces) of min. 26 GA galvanized or zinc/aluminum alloy coated steel with painted or mill finish, or min. 26 GA stainless steel with mill finish.
- B. POLYURETHANE FOAM CORE – Fill hollow core between panel faces (Item 1A) with nominal 2.17 pcf density polyurethane foam forming the male and female mating edges of the panels.

**2. SIDE JOINT SEALANT (Optional):**

- A. CF INSULATED METAL PANEL – Install a nominal 3/16 in. bead of one-component, urethane or butyl sealant, to the female edge of the panel on either the exterior, interior, or both sides prior to joining the insulated wall panels (Item 2).
- B. LS-36 INSULATED METAL PANEL (Not Shown) – Install a nominal 3/16 in. bead of one-component, urethane or butyl sealant, to the female edge of the panel on the interior side prior to joining the insulated wall panels (Item 2 “interior”). Install butyl tape sealant for the exterior lap joint.

*Consult the listing report on the Directory of Building Products (<https://bpdirectory.intertek.com>) for the edition of the standard(s) evaluated.*

*Compliance of the assembly described in this Design Listing with the referenced standard relies on verification that the assembly constructed in the field is consistent with that described herein. Intertek certified products may be verified by the approved Intertek label; other products must be verified by the Authority Having Jurisdiction as meeting the specifications stated herein.*