

**General Coatings Manufacturing Corp.**  
**Design No. GCM/FI 30-02**  
**Spray Polyurethane Foam**  
**UPC 2.0 HFO/Ultra-Thane 205 HFO**  
**NFPA 285**  
**Meets Requirements**

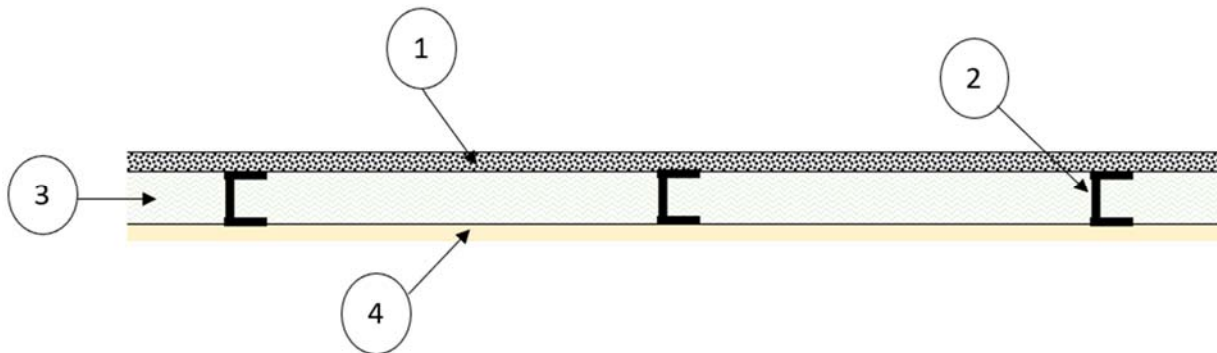

**1. GYPSUM BOARD:** Install min. 5/8 in. nominal thickness Type X gypsum board oriented with long dimension perpendicular to vertical framing (Item 2) and offset vertical joints. Attach to framing (Item 2) using # 6 x 1-1/4 in. long bugle-head screws spaced vertically 12 in. on center (oc) and 3/8 in. to 5/8 in. from edges of boards.

**2. FRAMING:** Install max. 6 in. deep and min. 3-5/8 in. deep, 20 GA galvanized steel studs and track with studs spaced max. 24 in. oc. Brace with cold-rolled channel (CRC) every 4 ft vertically. Secure steel studs horizontally to top and bottom tracks using #2- 8 x 1/2 in. self-drill zinc plated screws. In the stud cavity at the floor line, apply a min. 4 in. thick, 4 pcf mineral wool as fireblocking material.

**3. CERTIFIED MANUFACTURER:** General Coatings Manufacturing Corp.

**CERTIFIED PRODUCT:** Spray Polyurethane Foam

**CERTIFIED MODEL:** UPC 2.0 HFO/Ultra-Thane 205 HFO

Spray-apply the insulation to partially fill or to fully fill the steel stud cavity.

**4. EXTERIOR SHEATHING:** Install ASTM C1177 compliant, min. 5/8 in. nominal thickness, Type X Glass Mat Gypsum Sheathing oriented with long dimension perpendicular to vertical framing (Item 2) and offset vertical joints. Attach to framing (Item 2) using #6 x 1-1/4 in. long bugle-head screws spaced vertically 12 in. oc and 3/8-in. to 5/8-in. from edges of boards.

**5. EXTERIOR CLADDING (Optional, Not Shown):** Apply any of the following non-combustible claddings to the exterior:

A. **BRICK AND BRICK TIES/ANCHORS** – Install nominal 4 in. thick clay brick or veneer with max. 2 in. air gap, with brick ties/anchors spaced max. 16 in oc vertically and max. 24 in. oc horizontally (aligned with framing (Item 2)).

- B. STUCCO – Install min. 3/4 in. thick exterior cement plaster and lath.
- C. NATURAL STONE (GRANITE, LIMESTONE, MARBLE, SANDSTONE) – Install min. 2 in. thick natural stone using an approved installation technique with a max. 2 in. air gap.
- D. ARTIFICIAL CAST STONE – Install min. 1-1/2 in. thick artificial cast stone using an approved installation technique with a max. 2 in. air gap.
- E. TERRA COTTA – Install min. 1-1/4 in. thick terra cotta cladding using an approved installation technique with a max. 2 in. air gap.
- F. CONCRETE – Install min. 2 in. thick concrete with a max. 2 in. air gap.
- G. GLASS FIBER-REINFORCED CONCRETE PANELS – Install min. 1/4 in. thick panels per manufacturer's instructions.
- H. CMU BLOCKS – Install min. 4 in. thick blocks with max. 2 in. air gap.
- I. SHEET METAL – Install sheet metal cladding including steel, aluminum, copper, or zinc.

- 6. WATER-RESISTANT BARRIER (Optional, Not Shown):** Install a WRB under ASTM E136 compliant, non-combustible, min. 2 in. thick, min. 4 pcf mineral wool, with any of the approved exterior claddings (Item 5).

Alternatively, install a WRB that complies with the following performance and installation requirements:

- ASTM E1354 Performance:  
Peak heat release rate less than 150 kW/m<sup>2</sup>, and effective heat of combustion less than 18 MJ/kg when tested in the horizontal orientation at an incident radiant heat flux of 50 kW/m<sup>2</sup>
- ASTM E84 or UL 723 Performance:  
Flame Spread Index not to exceed 25, and Smoke Developed Index not to exceed 450
- When used in combination with stucco (Item 5B), use min. 7/8 in. thick exterior cement plaster and lath
- When used in combination with sheet metal (Item 5I), use min. 0.0149 in. thick steel only.

Consult the listing report on the Directory of Building Products (<https://bpdirectory.intertek.com>) for the edition of the standard(s) evaluated.