

ACCOR Technology Inc.
Design No. ACC/PF 120-01
Washing Machine Supply Outlet Box and Ice Maker Box
ASTM E814
Rating: F-Rating: 2 Hour, T-Rating: 74 Minutes

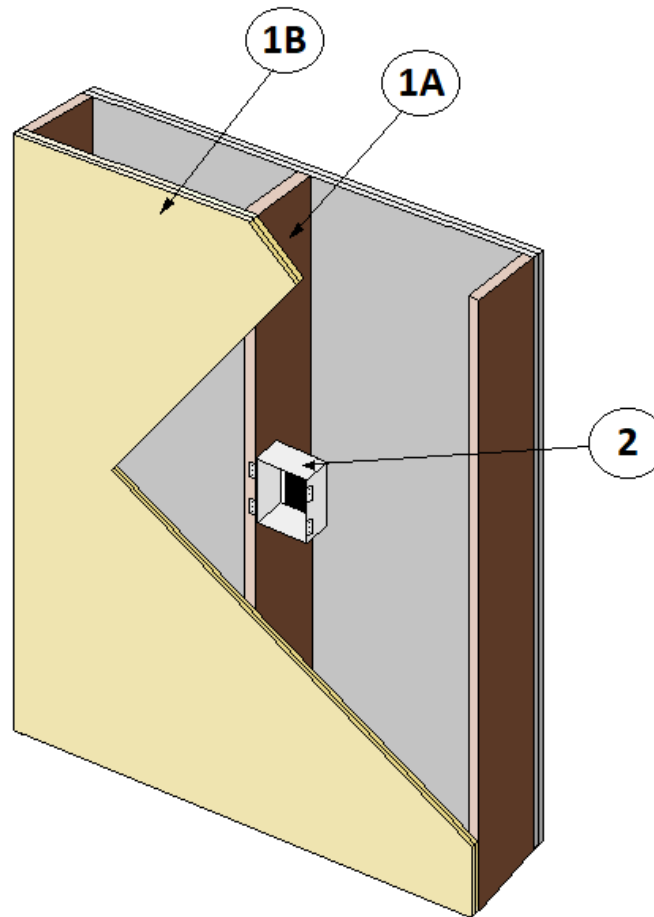

1. WALL ASSEMBLY: Use 2 hour fire-rated wall assembly (Non-Loadbearing Assemblies) consisting of the following min. construction:

A. **WOOD STUDS** – Nominal 2 x 4 wood studs spaced up to 24 in. on center (oc).

STEEL STUDS – Min. 26 GA steel studs spaced up to 24 in. oc.

B. **GYPSUM BOARD** – Cover studs and plates with two layers of 5/8 in. thick, Type X gypsum wallboard on each face. First layer gypsum wallboard fastened to wood studs with min. 1-1/4 in. drywall screws, spaced at max. 12 in. oc around the perimeter and across the field. Second layer gypsum wallboard fastened to wood studs with min. 1-5/8 in. drywall screws, spaced max. 12 in. oc around the perimeter and across the field.



2. PENETRATING ITEM: Incorporate the following construction features:

CERTIFIED MANUFACTURER: ACCOR Technology Inc.

CERTIFIED PRODUCTS: 4ALL Utility Box (Box Dimensions: 8.59 in. high, 7.6 in. wide, and 3.86 in. deep)

Installation is limited to a max. of one 4ALL Utility Box assembly in each wall cavity. Table 1 below shows a list of approved 4ALL Utility Box models.

A. Fasten the 4ALL Utility Box directly to stud using its side mounting brackets with nails or screws.

3. DRAINAGE PIPE: (Not Shown) Use a 2 in. diameter PVC drainage pipe attached to the underside of the Utility Box.

Table 1: Approved 4ALL Utility Box Models

| | | |
|--------------------|--------------------|--------------------|
| FR1 4OBPO5-2 | FR1 4VBPO5IP84-2 | FR1 PWBPO5-75-1APT |
| FR1 4OBPO5-2AP | FR1 4VBPO5IP84-2AP | FR1 PWBPO5-75-1B |
| FR1 4OBPO5IP6-2APC | FR1 4XBPO5-2 | FR1 PWBPO5-75-1T |
| FR1 4OBPO5IP84-2 | FR1 4XBPO5-2AP | FR1 VWBPO5-75-1APB |
| FR1 4OBPO5IP84-2AP | FR1 4XBPO5IP6-2APC | FR1 VWBPO5-75-1APT |
| FR1 4PBPO5-2 | FR1 4XBPO5IP6-2C | FR1 VWBPO5-75-1B |
| FR1 4PBPO5-2AP | FR1 4XBPO5IP84-2 | FR1 VWBPO5-75-1T |
| FR1 4PBPO5IP6-2APC | FR1 4XBPO5IP84-2AP | FR1 XWBPO5-75-1APB |
| FR1 4PBPO5IP84-2 | FR1 OWBPO5-75-1APB | FR1 XWBPO5-75-1APT |
| FR1 4PBPO5IP84-2AP | FR1 OWBPO5-75-1APT | FR1 XWBPO5-75-1B |
| FR1 4VBPO5-2 | FR1 OWBPO5-75-1B | FR1 XWBPO5-75-1T |
| FR1 4VBPO5-2AP | FR1 OWBPO5-75-1T | |
| FR1 4VBPO5IP6-2APC | FR1 PWBPO5-75-1APB | |

Consult the listing report on the Directory of Building Products (<https://bpdirectory.intertek.com>) for the edition of the standard(s) evaluated.

Compliance of the assembly described in this Design Listing with the referenced standard relies on verification that the assembly constructed in the field is consistent with that described herein. Intertek certified products may be verified by the approved Intertek label; other products must be verified by the Authority Having Jurisdiction as meeting the specifications stated herein.