

James Hardie Building Products
Design No. JH/FCS 60-05
James Hardie Fiber Cement Siding
ASTM E119, CAN/ULC S101

Non-Symmetrical, 1 Hour Non-Load-Bearing Wall Assembly (Rating applies to both sides)

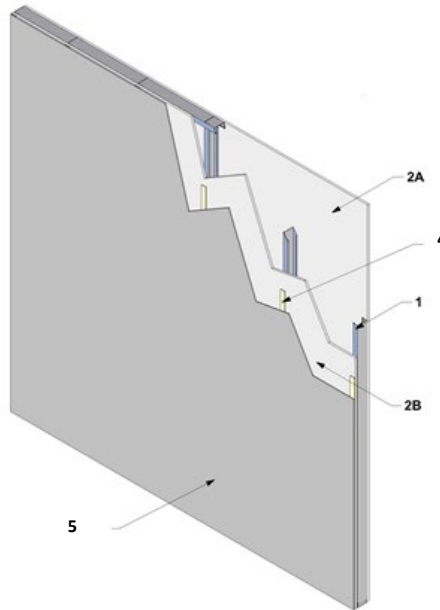

1. **STEEL STUDS:** Min. 3-5/8 in. depth, 20 GA (0.0359 in.) galvanized steel studs, spaced 24 in. on center (oc) max., with corresponding top and bottom tracks.
2. **GYPSUM WALLBOARD, SIDE A:** 1/2 in. Type X gypsum wallboard, applied horizontally or vertically and fastened with min. 1 in. Type S drywall screws, located 24 in. on floor and ceiling runners and intermediate studs. Base layer wallboard joints staggered 24 in. from those of base layer on opposite side of studs.

GYPSUM SHEATHING, SIDE B: 1/2 in. Type X gypsum sheathing, applied horizontally or vertically and fastened with min. 1 in. Type S drywall screws, located 24 in. on floor and ceiling runners and intermediate studs.

3. **WOOD SHEATHING (Optional, Not Shown):** Install one layer of wood structural panel sheathing on or behind Item 2B.
4. **FURRING (Optional):**
 - Min. 1-1/2 in. wide × 3/8 in. thick furring (Wood: Min. 0.42 s.g; Metal: Corrosion Resistance min. 20 GA 33 ksi metal hat channel, z-grit or u-bar), or
 - Min. 4.574 in. wide × 3/4 in. thick James Hardie Horizontal Steel Furring installed per manufacturer's installation instructions (min. 18 GA 33 ksi metal)
5. **FIBRE-CEMENT BOARD (Face Layer):** HardieBacker® EZ Grid®, HardieBacker® 500, HardieBacker® with HydroDefense™, and HardieBacker® Underlayment backerboard installed in accordance with the manufacturer's installation instructions.



Consult the listing report on the Directory of Building Products (<https://bpdirectory.intertek.com>) for the edition of the standard(s) evaluated.

Compliance of the assembly described in this Design Listing with the referenced standard relies on verification that the assembly constructed in the field is consistent with that described herein. Intertek certified products may be verified by the approved Intertek label; other products must be verified by the Authority Having Jurisdiction as meeting the specifications stated herein.