

**James Hardie Building Products
Design No. JH/FCS 60-06
James Hardie Fiber Cement Sidings
ASTM E119, CAN/ULC S101**

Non-Symmetrical, 1 Hour Non-Load-Bearing Wall Assembly (Rating applies to both sides)

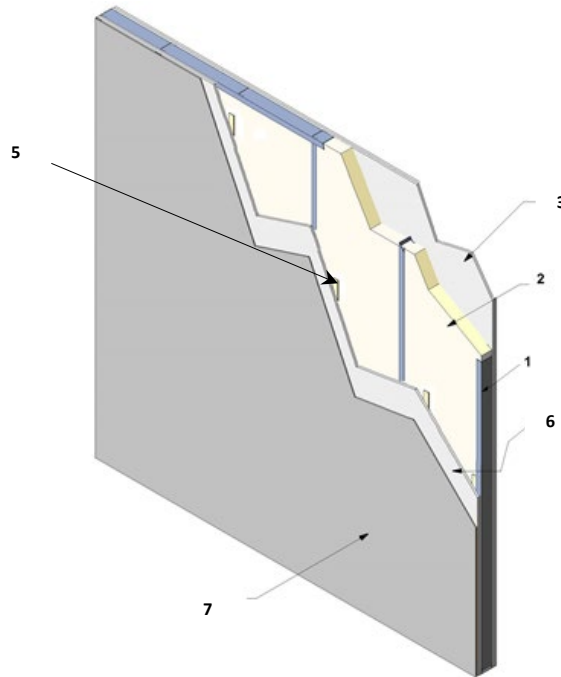

1. STEEL STUDS: Min. 3-5/8 in. depth, 25 GA galvanized steel studs, spaced 16 in. on center (oc).

2. INSULATION: Min. 3 in. thickness, 3 pcf mineral fiber batt insulation (rockwool), conforming to ASTM-C665 Type I, friction fit in joist cavities.

3. GYPSUM WALLBOARD: 5/8 in. Type X gypsum wallboard installed horizontally or vertically and fastened with min. 1-1/4 in. Type S drywall screws, 8 in. oc at board perimeter and in field areas of boards.

4. WOOD SHEATHING (Optional, Not Shown): Install one layer of wood structural panel sheathing on Item 1.

5. FURRING (Optional):

- Min. 1-1/2 in. wide × 3/8 in. thick furring (Wood: Min. 0.42 s.g.; Metal: Corrosion Resistant min. 20 GA 33 ksi metal hat channel, z-girt or u-bar), or
- Min. 4.574 in. wide × 3/4 in. thick James Hardie Horizontal Steel furring installed per manufacturer's installation instructions (min. 18 GA 33 ksi metal)

6. CERTIFIED MANUFACTURER: James Hardie Building Products Inc.

CERTIFIED PRODUCT: HardieBacker® EZ Grid®, HardieBacker® 500, HardieBacker® with HydroDefense™, and HardieBacker® Underlayment backerboard.



FIBRE-CEMENT EXTERIOR SIDING, SIDE B:

HardieBacker® EZ Grid®, HardieBacker® 500, HardieBacker® with HydroDefense™, and HardieBacker® Underlayment backerboard installed in accordance with the manufacturer's installation instructions.

- 7. CERAMIC TILE:** Nominal 4 in. × 4 in. × 1/4 in. standard grade ceramic wall tile on the fire-exposed side.

Consult the listing report on the Directory of Building Products (<https://bpdirectory.intertek.com>) for the edition of the standard(s) evaluated.

Compliance of the assembly described in this Design Listing with the referenced standard relies on verification that the assembly constructed in the field is consistent with that described herein. Intertek certified products may be verified by the approved Intertek label; other products must be verified by the Authority Having Jurisdiction as meeting the specifications stated herein.