

ALLCOMB, Inc.
Design No. ALL/CWP 30-01
Non-Load Bearing Wall System
ALLCOMB Panels
NFPA 285
Rating: Meets Conditions of Acceptance

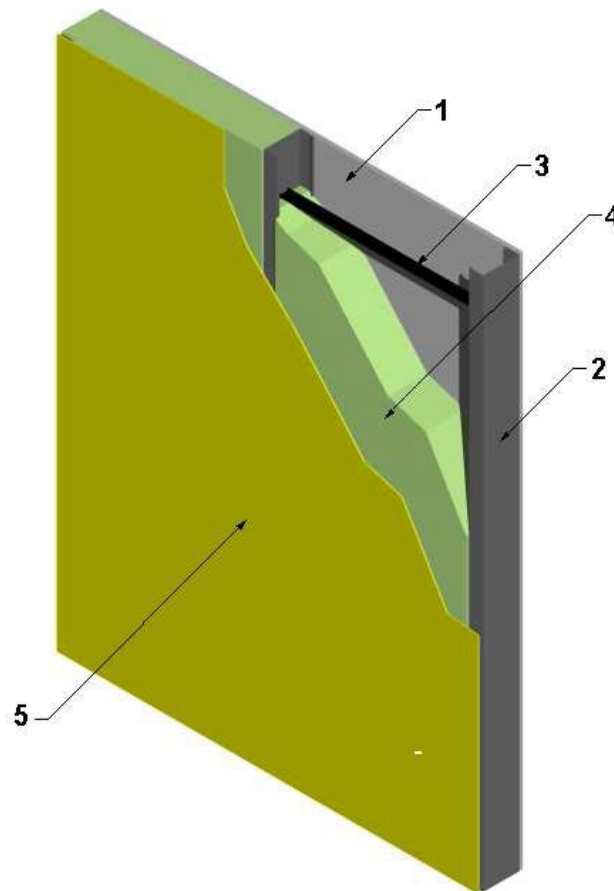

1. INTERIOR CLADDING: Install nominal 5/8 in. Type X gypsum board with long dimension perpendicular to steel studs (Item 2). Attach to steel studs (Item 2) using min. #6 Type S, 1-1/4 in. long bugle-head screws spaced 8 in. on center (oc) around perimeter and 12 in. oc in the field.

A. JOINT TAPE AND COMPOUND – (Not Shown) Joints and fasteners in the gypsum board (Item 1) have a Level 2 finish complying with GA-216 or ASTM C840.

2. STEEL STUDS: Use min. 3-5/8 in. deep, 16 GA, galvanized steel studs spaced a max. of 24 in. oc. Secure steel studs to 20 GA top and bottom tracks using min. 1/2 in. long self-drilling pan-head framing screws.

Steel studs must be laterally braced with 16 GA steel spaced max. 48 in. oc vertically.

3. EXTERIOR SHEATHING: Min. 5/8 in. thick DensGlass Gold Exterior Sheathing (Georgia Pacific) installed with the long edge



perpendicular to the studs; secured with #6 × 1-1/4 in. self-drilling screws spaced max. 8 in. oc around the perimeter and 12 in. oc in the field.

4. **WATER-RESISTIVE BARRIER:** Tyvek Commercial Wrap applied horizontally over the exterior sheathing with 4 in. overlap at horizontal joints.
5. **EXTERIOR INSULATION:** 3 in. thick 4 pcf Roxul Cavity Rock mineral wool insulation installed with long dimension parallel to the studs and secured in place with 20 GA galvanized steel 1-1/2 in. × 3 in. Z-profile subgirts.
6. **PANEL SUPPORT SYSTEM:** (Not Shown) 20 GA, 1-1/2 in. × 3 in. galvanized steel Z-profile subgirts are attached vertically to the studs using Buildex Tex #12 × 1-1/2 in. hex-head self-drilling screws spaced per design but no greater than 16 in. oc vertically.

The 3-1/2 in. wide TC-1A Rails are installed perpendicular to studs and z-girts, and are attached to the z-girts using Buildex Tek #14 × 2-1/2 in. hex-head self-drilling screws spaced per design but no greater than 16 in. oc.

7. EXTERIOR CLADDING:

CERTIFIED PRODUCT: ALLCOMB Panels

The panels are non-load bearing exterior wall cladding panels consisting of an aluminum honeycomb core with an interior facing of 1mm aluminum and an exterior facing of stone or porcelain. The panels are nominally 1 in. thick.

The panels have factory-attached clips on the interior face. The spacing of the clips will vary depending on the panel size but shall be no greater than 30 in. horizontally and vertically. Each panel shall have a min. of four clips.

A min. 1 in. air gap is required between exterior insulation and interior face of the panels.

JOINTS – Vertical joints between panels must be a min. of 36 in. above any opening and must be offset from joints in the adjoining row a min. of 39 in. or the width of the opening, whichever is less. Panel joints must be filled with H.B. Fuller Firesound sealant or Dow Corning 795 Silicone Building Sealant.

8. **OPENINGS:** (Not Shown) Openings must be covered with 12-1/4 in. × 3 in., 20 GA galvanized steel flashing, secured to the wall framing using #6 × 1-1/4 in. self-drilling, zinc-plated, bugle-head screws spaced a max. of 12 in. oc.
9. **FLOOR LINES:** (Not Shown) Min. 4 in., 4 pcf Thermafiber mineral wool is compression fit in each stud cavity at the floor lines.

Consult the listing report on the Directory of Building Products (<https://bpdirectory.intertek.com>) for the edition of the standard(s) evaluated.

Compliance of the assembly described in this Design Listing with the referenced standard relies on verification that the assembly constructed in the field is consistent with that described herein. Intertek certified products may be verified by the approved Intertek label; other products must be verified by the Authority Having Jurisdiction as meeting the specifications stated herein.